

Outline Dimensions

UU188

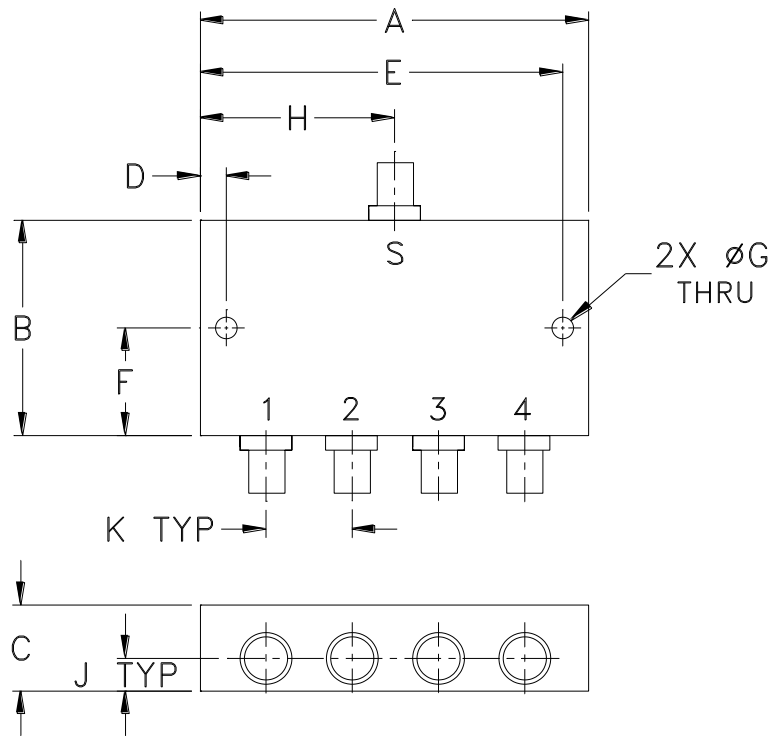

CASE#	A	B	C	D	E	F	G	H	J	K	WT. GRAMS
UU188	3.50 (88.90)	2.13 (54.10)	.88 (22.35)	.150 (3.81)	3.350 (85.09)	1.06 (26.92)	.125 (3.18)	1.75 (44.45)	.44 (11.18)	.89 (22.61)	260

Dimensions are in inches (mm). Tolerances: 2 Pl. $\pm .03$; 3 Pl. $\pm .015$

Notes:

- Case material: Aluminum alloy.
- Case finish:
For RoHS Case Styles: Clear chemical conversion coating, non-chrome or trivalent chrome based.
- Refer to the individual model data sheet for the type of connectors available.



P.O. Box 350166, Brooklyn, New York 11235-0003 (718) 934-4500 Fax (718) 332-4661 For detailed performance specs & shopping online see Mini-Circuits web site



The Design Engineers Search Engine Provides ACTUAL Data Instantly From MINI-CIRCUITS At: www.minicircuits.com

RF/IF MICROWAVE COMPONENTS