

Coaxial-Ceramic Resonator Filters and Multiplexers

50Ω DC to 6 GHz



The Big Deal

- Low insertion loss with excellent power handling
- Passbands up to 6 GHz
- Fractional bandwidth from <1 to 25%
- Excellent temperature stability
- Rugged construction to handle demanding environmental conditions

Product Overview

Mini-Circuits' *Coaxial-Ceramic Resonator filters* offer low insertion loss in very small form factors, using ceramic material with high dielectric constant and superior Q factor. Bandpass and bandstop filters, diplexer and multiplexer designs can be constructed using this technology. Low insertion loss combined with excellent power handling makes these filters well suited for transmitter and receiver signal chains. Advanced filter design and construction can achieve stopband width greater than 3x the center frequency

All our coaxial-ceramic resonator filters are built with rugged construction. Excellent repeatability across units is achieved through precise tuning and process control.

Key Features

Feature	Advantages
Low insertion loss	Low signal loss results in better SNR in signal chain
Fast roll-off	Higher selectivity results in better adjacent channel rejection and dynamic range
Wide stop band	Wide spur-free stopband results in better receiver sensitivity
Excellent power handling	Well suited for transmitter applications
Rugged Construction	These filter assemblies have been qualified over a wide range of thermal, mechanical and environmental conditions including withstanding the stress of extensive solder reflow cycles
Small Size	Very well suited for high performance applications where size is a constraint.
Temperature stability	Very minimal change in electrical performance across temperature makes these filters suitable for a wide range of operating conditions.

Notes

- A. Performance and quality attributes and conditions not expressly stated in this specification document are intended to be excluded and do not form a part of this specification document.
 B. Electrical specifications and performance data contained in this specification document are based on Mini-Circuit's applicable established test performance criteria and measurement instructions.
 C. The parts covered by this specification document are subject to Mini-Circuits standard limited warranty and terms and conditions (collectively, "Standard Terms"); Purchasers of this part are entitled to the rights and benefits contained therein. For a full statement of the Standard Terms and the exclusive rights and remedies thereunder, please visit Mini-Circuits' website at www.minicircuits.com/MCLStore/terms.jsp



Bandpass Filter

ZX75BP-B1230-S+

50Ω 1120 to 1340 MHz



Generic photo used for illustration purposes only
CASE STYLE: HY1238

Features

- Low insertion loss
- High selectivity
- Connectorized package

Applications

- Aeronautical navigation
- Mobile radio
- Radar system
- Aviation

Electrical Specifications at 25°C

Parameter		F#	Frequency (MHz)	Min.	Typ.	Max.	Unit
Pass Band	Center Frequency	—	—	—	1230	—	MHz
	Insertion Loss	F1-F2	1120 - 1340	—	0.9	1.8	dB
	VSWR	F1-F2	1120 - 1340	—	1.3	2.0	:1
Stop Band, Lower	Insertion Loss	DC-F3	DC - 700	60	70	—	dB
		F3-F4	700 - 830	40	45	—	dB
	VSWR	F4-F5	830 - 940	20	25	—	dB
Stop Band, Upper	Insertion Loss	DC-F5	DC - 940	—	20	—	:1
		F6-F7	1750 - 2050	25	30	—	dB
	F7-F8	2050 - 2400	45	50	—	dB	
	VSWR	F8-F9	2400 - 3500	—	20	—	:1
F6-F8	1750 - 3500	—	20	—	—	:1	

Maximum Ratings

Operating Temperature	-40°C to 85°C
Storage Temperature	-55°C to 100°C
RF Power Input	5 W

Permanent damage may occur if any of these limits are exceeded.

Functional Schematic

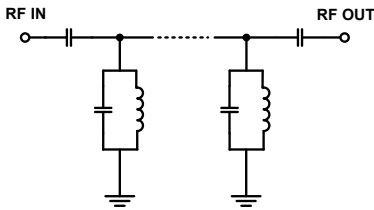

Typical Performance Data at 25°C

Frequency (MHz)	Insertion Loss (dB)	VSWR (:1)	Frequency (MHz)	Group Delay (nSec)
1	102.57	135083.82	1120	3.90
100	102.27	2105.31	1130	3.73
210	99.30	757.65	1140	3.59
400	110.78	292.42	1150	3.46
700	72.56	123.97	1160	3.35
830	50.25	93.78	1170	3.25
940	30.03	64.33	1180	3.15
985	20.15	43.50	1190	3.06
1054	3.12	3.43	1200	2.98
1100	0.86	1.16	1210	2.91
1120	0.81	1.20	1220	2.86
1230	0.76	1.32	1230	2.83
1340	0.72	1.14	1240	2.80
1320	0.69	1.10	1250	2.77
1600	19.16	55.68	1260	2.76
1640	22.47	64.52	1270	2.75
1750	30.59	79.43	1280	2.74
2050	57.32	87.17	1290	2.75
2400	70.71	83.44	1300	2.75
3500	44.37	43.56	1340	2.85

Typical Frequency Response

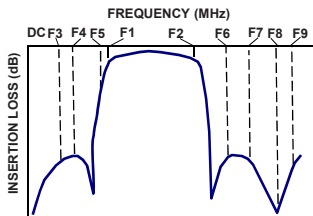

+RoHS Compliant

The +Suffix identifies RoHS Compliance. See our web site for RoHS Compliance methodologies and qualifications

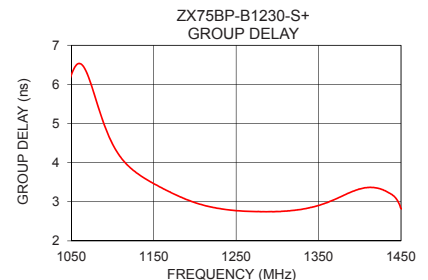
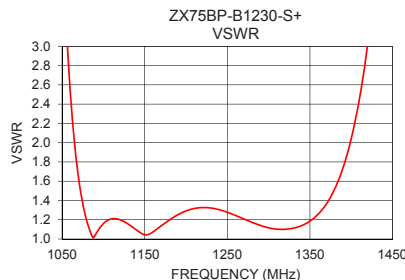
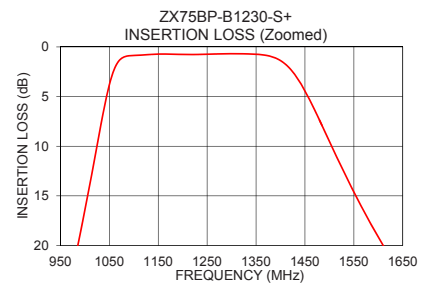
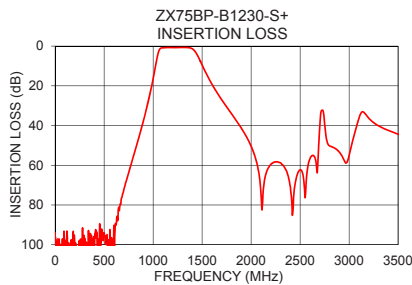

Notes

- Performance and quality attributes and conditions not expressly stated in this specification document are intended to be excluded and do not form a part of this specification document.
- Electrical specifications and performance data contained in this specification document are based on Mini-Circuit's applicable established test performance criteria and measurement instructions.
- The parts covered by this specification document are subject to Mini-Circuits standard limited warranty and terms and conditions (collectively, "Standard Terms"); Purchasers of this part are entitled to the rights and benefits contained therein. For a full statement of the Standard Terms and the exclusive rights and remedies thereunder, please visit Mini-Circuits' website at www.minicircuits.com/MCLStore/terms.jsp



Coaxial Connections

PORT - 1	SMA-MALE
PORT - 2	SMA-FEMALE

Outline Drawing

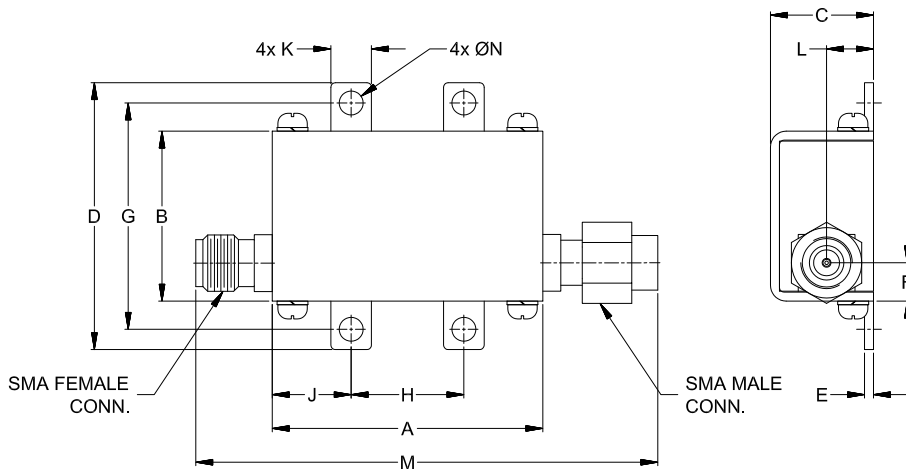

Outline Dimensions ($\frac{\text{inch}}{\text{mm}}$)

A	B	C	D	E	F	G
1.20	.75	.46	1.18	.04	.17	1.00
30.48	19.05	11.68	29.97	1.02	4.32	25.40
H	J	K	L	M	N	Wt.
.50	.35	.18	.21	2.05	.106	grams
12.70	8.89	4.57	5.28	52.07	2.69	35.0

Note: Please refer to case style drawing for details

Notes

- A. Performance and quality attributes and conditions not expressly stated in this specification document are intended to be excluded and do not form a part of this specification document.
- B. Electrical specifications and performance data contained in this specification document are based on Mini-Circuit's applicable established test performance criteria and measurement instructions.
- C. The parts covered by this specification document are subject to Mini-Circuits standard limited warranty and terms and conditions (collectively, "Standard Terms"); Purchasers of this part are entitled to the rights and benefits contained therein. For a full statement of the Standard Terms and the exclusive rights and remedies thereunder, please visit Mini-Circuits' website at www.minicircuits.com/MCLStore/terms.jsp



Typical Performance Data

FREQ. (MHz)	INSERTION LOSS			INPUT RETURN LOSS			OUTPUT RETURN LOSS		
	(dB)			(dB)			(dB)		
	@-40°C	@+25°C	@+85°C	@-40°C	@+25°C	@+85°C	@-40°C	@+25°C	@+85°C
1	96.78	102.57	104.38	0.00	0.00	0.00	0.00	0.00	0.00
5	103.36	105.46	104.27	0.00	0.00	0.00	0.00	0.00	0.00
10	100.92	102.68	105.41	0.00	0.00	0.00	0.00	0.00	0.00
50	97.88	99.89	103.80	0.01	0.01	0.01	0.01	0.01	0.02
90	104.43	93.49	103.21	0.00	0.01	0.01	0.01	0.02	0.03
130	97.31	108.68	96.57	0.01	0.02	0.02	0.02	0.04	0.05
170	103.83	110.52	97.36	0.00	0.02	0.03	0.03	0.06	0.07
210	102.45	99.30	98.62	0.01	0.02	0.03	0.05	0.08	0.10
250	101.95	107.45	104.21	0.01	0.03	0.04	0.07	0.10	0.12
290	112.45	103.92	101.64	0.01	0.04	0.05	0.10	0.13	0.16
330	108.87	102.20	106.66	0.02	0.05	0.06	0.13	0.17	0.19
370	93.43	95.46	100.69	0.02	0.05	0.07	0.16	0.20	0.23
410	123.19	93.73	97.39	0.03	0.06	0.07	0.19	0.24	0.27
450	92.47	100.46	94.64	0.04	0.07	0.09	0.22	0.28	0.32
490	99.70	97.87	101.69	0.04	0.08	0.10	0.26	0.32	0.36
530	94.39	95.09	91.34	0.05	0.09	0.11	0.29	0.36	0.40
570	101.48	102.32	104.16	0.06	0.10	0.12	0.32	0.39	0.44
700	72.55	72.56	72.41	0.09	0.14	0.16	0.41	0.51	0.57
830	50.33	50.25	50.02	0.13	0.19	0.21	0.47	0.59	0.67
930	32.25	32.04	31.71	0.19	0.26	0.30	0.49	0.62	0.72
940	30.26	30.03	29.68	0.21	0.27	0.32	0.49	0.63	0.73
970	23.90	23.61	23.22	0.26	0.33	0.40	0.51	0.66	0.77
1010	14.29	13.91	13.49	0.54	0.68	0.84	0.72	0.92	1.09
1050	4.00	3.84	3.74	3.54	4.16	4.86	3.55	4.17	4.72
1090	0.71	0.90	1.07	36.74	34.50	31.58	24.19	23.98	22.86
1100	0.69	0.86	1.03	22.15	22.64	22.64	20.67	21.13	21.23
1110	0.67	0.84	0.99	19.54	20.50	20.94	18.74	19.62	20.26
1120	0.65	0.81	0.95	19.48	20.82	21.55	18.67	19.83	20.74
1130	0.62	0.78	0.91	20.95	22.86	23.92	19.85	21.34	22.50
1140	0.58	0.74	0.89	23.91	27.01	28.75	22.15	24.14	25.61
1150	0.56	0.72	0.86	28.19	33.40	35.62	25.32	27.92	29.44
1170	0.55	0.72	0.86	24.35	23.92	23.85	24.58	24.96	24.87
1210	0.60	0.76	0.89	17.11	17.29	17.70	17.39	17.90	18.29
1230	0.61	0.76	0.88	16.74	17.17	17.73	16.80	17.49	17.99
1290	0.53	0.69	0.81	21.76	23.68	24.95	20.86	22.39	23.03
1330	0.53	0.70	0.83	23.57	25.49	25.67	22.73	23.86	23.55
1340	0.54	0.72	0.85	22.48	23.74	23.59	21.82	22.46	21.95
1433	2.63	3.04	3.35	4.50	4.37	4.26	5.09	5.01	4.95
1450	3.97	4.43	4.76	2.91	2.88	2.84	3.52	3.57	3.61
1490	8.00	8.46	8.80	1.08	1.16	1.21	1.70	1.90	2.04
1530	12.24	12.63	12.94	0.49	0.59	0.65	1.10	1.34	1.51
1570	16.15	16.50	16.78	0.29	0.38	0.45	0.88	1.13	1.30
1610	19.70	20.02	20.28	0.21	0.30	0.36	0.79	1.03	1.20
1650	22.96	23.26	23.51	0.18	0.26	0.32	0.74	0.98	1.14
1690	25.99	26.29	26.52	0.17	0.24	0.29	0.72	0.94	1.09
1730	28.90	29.18	29.40	0.16	0.23	0.28	0.70	0.91	1.06
1750	30.31	30.59	30.81	0.15	0.22	0.27	0.70	0.90	1.05
1810	34.52	34.77	34.98	0.14	0.21	0.26	0.70	0.88	1.02
1850	37.35	37.61	37.78	0.14	0.21	0.26	0.70	0.88	1.01
1890	40.32	40.55	40.72	0.14	0.20	0.25	0.72	0.89	1.01
1930	43.49	43.72	43.86	0.13	0.20	0.25	0.73	0.89	1.01
1970	47.09	47.33	47.44	0.13	0.20	0.25	0.75	0.90	1.02
2010	51.35	51.56	51.70	0.13	0.20	0.25	0.78	0.93	1.05
2050	57.29	57.32	57.49	0.13	0.20	0.25	0.82	0.97	1.10
2090	67.72	67.92	68.54	0.12	0.20	0.26	0.86	1.02	1.16
2130	69.49	69.94	69.68	0.12	0.20	0.26	0.92	1.09	1.25
2300	58.95	58.82	58.91	0.12	0.20	0.27	1.40	1.74	2.07
2350	61.77	61.84	61.81	0.12	0.20	0.28	1.66	2.10	2.53
2400	70.71	70.71	71.29	0.12	0.21	0.29	2.02	2.59	3.14
3500	44.11	44.37	44.57	0.22	0.40	0.57	0.62	0.86	1.05

Typical Performance Data

FREQ. (MHz)	GROUP DELAY		
	(ns)		
	@-40°C	@+25°C	@+85°C
1120	3.94	3.90	3.87
1125	3.84	3.81	3.78
1130	3.75	3.73	3.70
1135	3.68	3.65	3.63
1140	3.61	3.59	3.56
1145	3.55	3.52	3.50
1150	3.49	3.46	3.44
1155	3.44	3.41	3.38
1160	3.38	3.35	3.33
1165	3.33	3.30	3.27
1170	3.27	3.25	3.22
1175	3.22	3.19	3.17
1180	3.17	3.15	3.13
1185	3.12	3.10	3.08
1190	3.08	3.06	3.04
1195	3.03	3.02	3.00
1200	3.00	2.98	2.96
1205	2.96	2.94	2.93
1210	2.93	2.91	2.90
1215	2.90	2.89	2.88
1220	2.87	2.86	2.85
1225	2.85	2.84	2.84
1230	2.83	2.83	2.82
1235	2.81	2.81	2.80
1240	2.80	2.80	2.79
1245	2.79	2.78	2.78
1250	2.78	2.77	2.77
1255	2.77	2.77	2.76
1260	2.76	2.76	2.76
1265	2.76	2.75	2.75
1270	2.75	2.75	2.75
1275	2.75	2.75	2.74
1280	2.75	2.74	2.74
1285	2.75	2.75	2.74
1290	2.75	2.75	2.74
1295	2.75	2.75	2.75
1300	2.75	2.75	2.75
1305	2.76	2.76	2.76
1310	2.76	2.76	2.76
1315	2.77	2.77	2.77
1320	2.78	2.78	2.78
1321	2.78	2.78	2.78
1322	2.78	2.79	2.79
1323	2.79	2.79	2.79
1325	2.79	2.80	2.80
1330	2.80	2.81	2.81
1335	2.82	2.83	2.83
1336	2.83	2.83	2.84
1338	2.83	2.84	2.85
1339	2.84	2.85	2.85
1340	2.85	2.85	2.86

Typical Performance Curves

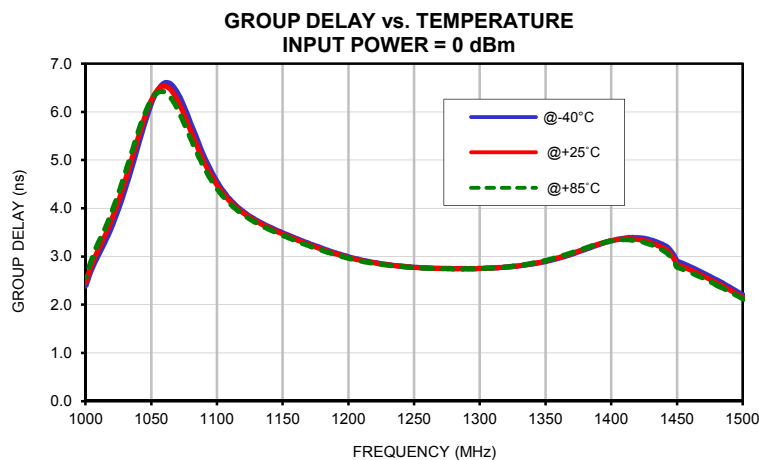
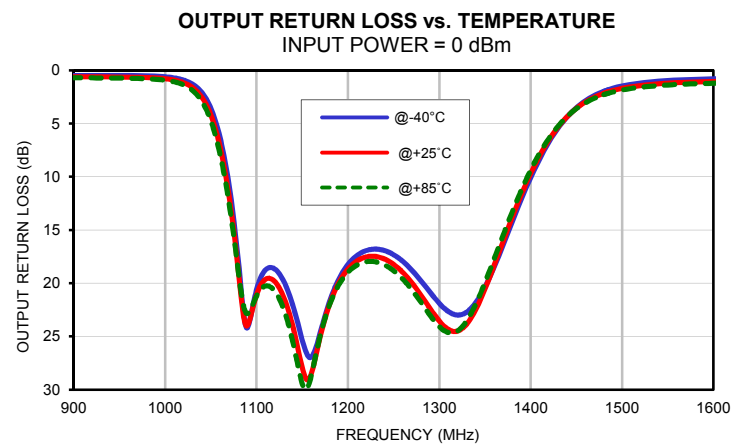
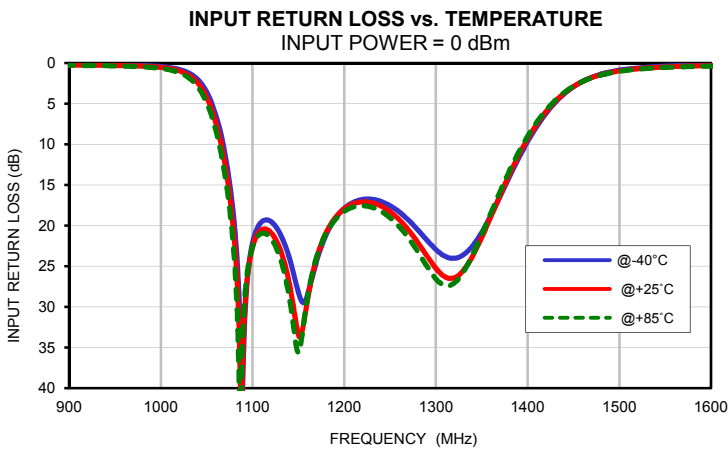
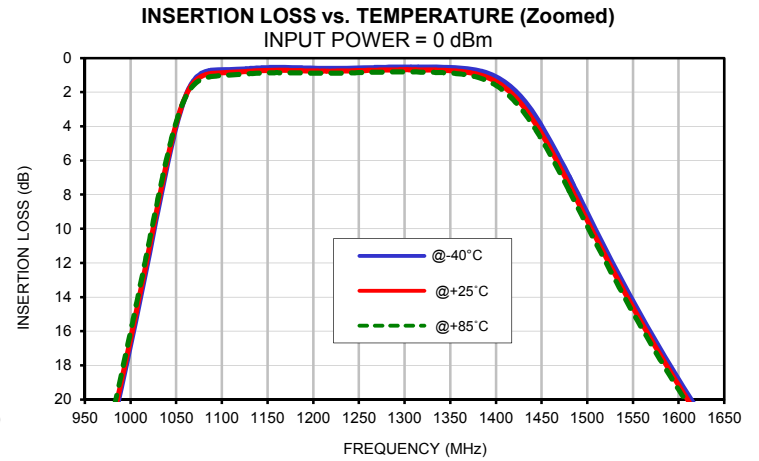
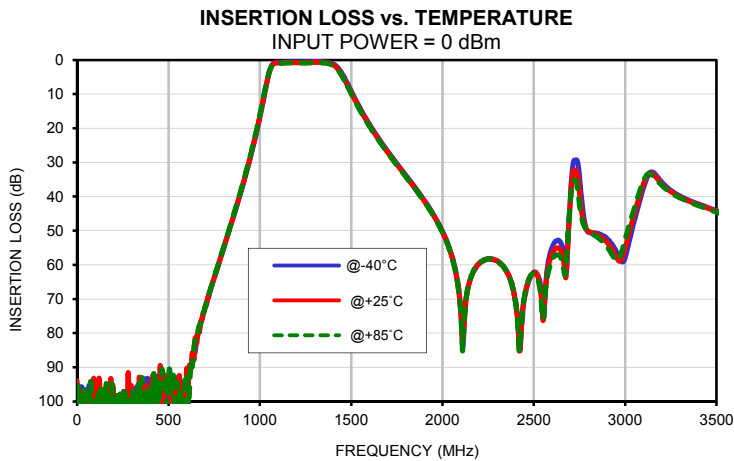

Case Style

HY

Outline Dimensions

HY1238

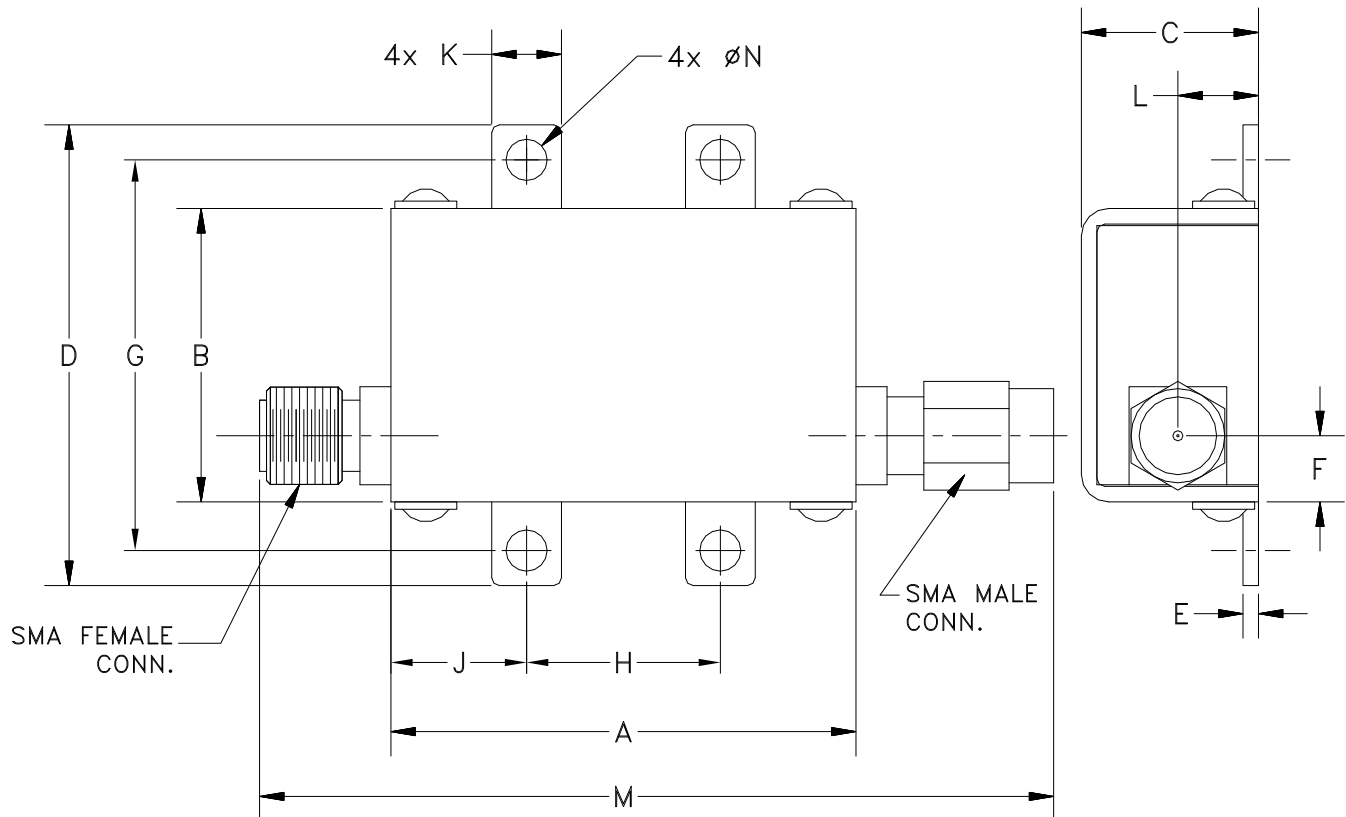

CASE #.	A	B	C	D	E	F	G	H	J	K	L	M	N	WT GRAMS
HY1238	1.20 (30.48)	.75 (19.05)	.46 (11.68)	1.18 (29.97)	.04 (1.02)	.17 (4.32)	1.00 (25.40)	.50 (12.70)	.35 (8.89)	.18 (4.57)	.21 (5.28)	2.05 (52.07)	.106 (2.69)	35.0

Dimensions are in inches (mm). Tolerances: 2Pl. $\pm .03$; 3Pl. $\pm .015$
 Tolerance on hole size and interaxes dimensions to be $\pm .005$.

Note:

1. Case material: Brass
2. Case finish: Nickel plate

Mini-Circuits®

INTERNET <http://www.minicircuits.com>

P.O. Box 350166, Brooklyn, New York 11235-0003 (718) 934-4500 Fax (718) 332-4661

Distribution Centers NORTH AMERICA 800-654-7949 • 417-335-5935 • Fax 417-335-5945 • EUROPE 44-1252-832600 • Fax 44-1252-837010

Mini-Circuits ISO 9001 & ISO 14001 Certified

All Mini-Circuits products are manufactured under exacting quality assurance and control standards, and are capable of meeting published specifications after being subjected to any or all of the following physical and environmental test.

Specification	Test/Inspection Condition	Reference/Spec
Operating Temperature	-55° to 100°C Ambient Environment	Individual Model Data Sheet
Storage Temperature	-55° to 100° C Ambient Environment	Individual Model Data Sheet
Humidity	90 to 95% RH, 40°C, 96 hours; Units may require bake-out after humidity to restore full performance.	MIL-STD-202, Method 103, Condition B
Thermal Shock	-55° to 100°C, 100 cycles	MIL-STD-202, Method 107, Condition A-3, except +100°C
Vibration (High Frequency)	20g peak, 10-2000 Hz, 12 times in each of three perpendicular directions (total 36)	MIL-STD-202, Method 204, Condition D
Mechanical Shock	50g, 11ms half-sine, 3 shocks each direction 3 axes (total 18)	MIL-STD-202, Method 213, Condition A