

# Coaxial Switch

## ZFSW-2-46

50Ω SPDT, Reflective DC<sup>5</sup> to 4.6 GHz

### Maximum Ratings

Operating Temperature	-55°C to 100°C
Storage Temperature	-55°C to 150°C
Input Power	see Note 1
Control V	see Note 2

Permanent damage may occur if any of these limits are exceeded.

### Coaxial Connections

RF IN	s
RF OUT 1	3
RF OUT 2	2
CONTROL 1	4
CONTROL 2	1

### Outline Drawing

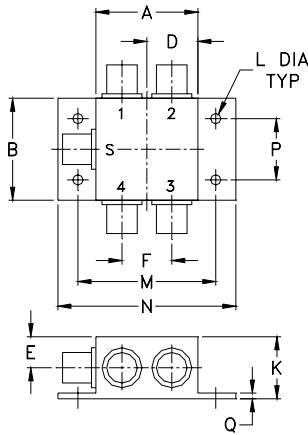

### Outline Dimensions (inch/mm)

A	B	C	D	E	F	G	H
1.25	1.25	--	.63	.38	.61	--	--
31.75	31.75	--	16.00	9.65	15.49	--	--
J	K	L	M	N	P	Q	wt
--	.76	.125	1.688	2.18	.75	.07	grams
--	19.30	3.18	42.88	55.37	19.05	1.78	85.0

### Features

- wideband, DC to 4.6 GHz
- high isolation, 50 dB typ.
- excellent VSWR, 1.3:1 typ

### Applications

- instrumentation
- communication systems
- laboratory



Generic photo used for illustration purposes only

CASE STYLE: G144

Connectors	Model
SMA	ZFSW-2-46

### Electrical Specifications

FREQ. <sup>5</sup> (GHz)	INSERTION LOSS (dB)						1dB COMPR. (dBm)			IN-OUT ISOLATION (dB)						
	DC-200 MHz		200-1000 MHz		1000-4600 MHz		DC-200 MHz	200-1000 MHz	1000-4600 MHz	DC-200 MHz		200-1000 MHz		1000-4600 MHz		
f <sub>L</sub>	f <sub>U</sub>	Typ.	Max.	Typ.	Max.	Typ.	Max.	Typ.	Typ.	Typ.	Typ.	Min.	Typ.	Min.	Typ.	Min.
DC	4.6	0.9	1.1	1.0	1.3	1.3	1.8*	10	17	27	60	50	50	40	40	28

\*1.8 dB max up to 3 GHz, 2.8 dB max 3-4.6 GHz

### Additional Specifications

Control Voltage, volts	
Low State	-0.2 to 0
High State (negative)	
for compression specs	-8
for other specs	-5 to -8
Control Current, mA	2.5 typ. at -8V
VSWR(:1)	1.3 typ.
Rise/Fall time (10%-90%), ns	2 typ.
Switching time, 50% of Control to 90% RF (Turn-on), ns	4 typ.
10% RF (Turn-off), ns	2.5 typ.
Video Leakage, mVp-p 0/-5V Control	30 typ.

1. Max Input RF power, +30 dBm except 100-500 MHz +27 dBm, and DC-100 MHz +24 dBm
2. Control voltage (-10V) maximum.
3. Video leakage or break through is defined as leakage of switching signal to RF output ports.
4. OFF state at RF output is low impedance.
5. All RF connections must be DC blocked or held at 0V DC.

### CONTROL LOGIC

Control Ports		RF outputs	
1	2	1	2
-V	0	On	Off
0	-V	Off	On

### Electrical Schematic

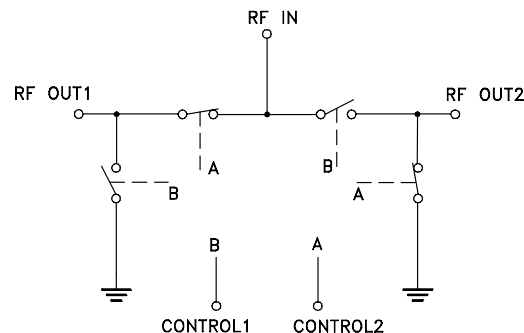

### Notes

- Performance and quality attributes and conditions not expressly stated in this specification document are intended to be excluded and do not form a part of this specification document.
- Electrical specifications and performance data contained in this specification document are based on Mini-Circuit's applicable established test performance criteria and measurement instructions.
- The parts covered by this specification document are subject to Mini-Circuit's standard limited warranty and terms and conditions (collectively, "Standard Terms"); Purchasers of this part are entitled to the rights and benefits contained therein. For a full statement of the Standard Terms and the exclusive rights and remedies thereunder, please visit Mini-Circuit's website at [www.minicircuits.com/MCLStore/terms.jsp](http://www.minicircuits.com/MCLStore/terms.jsp)



## Typical Performance Data

FREQ. (MHz)	ON INSERTION LOSS (dB) CONTROL @ 0V/-5V IN-OUT		OFF ISOLATION (dB) CONTROL @ 0V/-5V IN-OUT		VSWR IN	VSWR ON	VSWR OUT OFF
	$\bar{x}$	$\sigma$	$\bar{x}$	$\sigma$			
3.00	0.54	0.04	83.44	4.68	1.12	1.12	16.46
5.00	0.54	0.04	83.46	2.97	1.12	1.12	16.21
10.00	0.54	0.04	81.44	2.66	1.12	1.12	16.21
20.00	0.61	0.06	76.29	2.13	1.12	1.12	16.04
50.00	0.59	0.04	69.27	0.92	1.12	1.12	15.37
100.00	0.62	0.04	66.59	1.42	1.12	1.12	14.63
200.00	0.65	0.04	61.43	0.74	1.12	1.12	14.00
500.00	0.70	0.04	53.61	0.93	1.13	1.13	12.83
911.55	0.75	0.04	47.64	0.59	1.14	1.15	11.86
1000.00	0.76	0.04	46.91	0.61	1.14	1.16	11.79
1581.00	0.92	0.05	41.27	0.47	1.22	1.20	11.85
2107.00	0.92	0.06	37.77	0.41	1.36	1.21	11.91
2370.00	0.88	0.06	37.33	0.42	1.37	1.26	9.64
2489.55	1.01	0.07	36.86	0.43	1.41	1.34	9.98
2752.55	1.17	0.09	35.65	0.39	1.51	1.42	9.70
3278.55	1.15	0.11	33.10	0.42	1.53	1.39	13.14
3804.55	1.16	0.08	33.46	0.37	1.50	1.35	13.37
4330.55	0.87	0.05	31.99	0.42	1.31	1.24	15.41
4474.00	0.70	0.04	32.16	0.40	1.23	1.23	17.84
4600.00	1.08	0.04	32.78	0.42	1.13	1.16	14.40

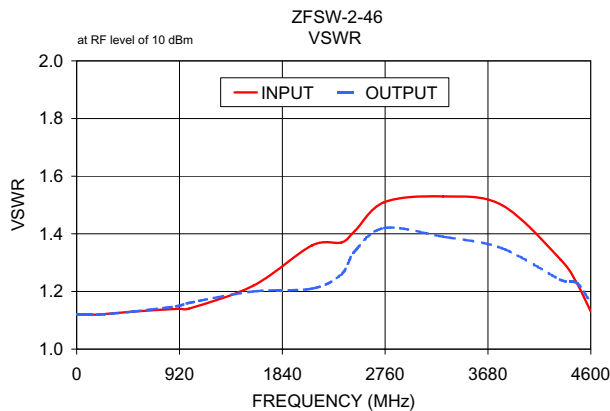
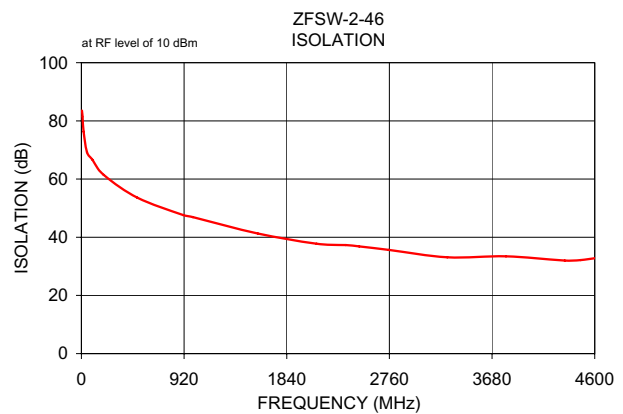
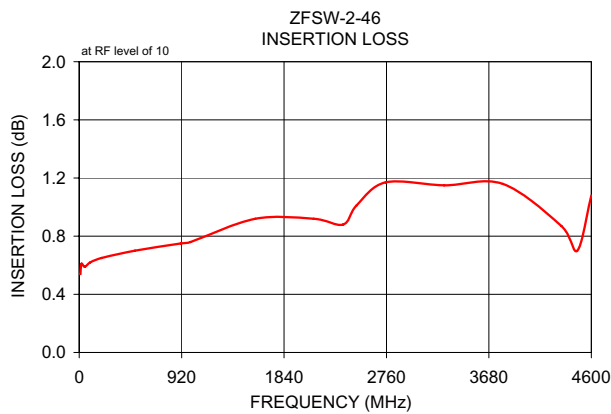

### Notes

- A. Performance and quality attributes and conditions not expressly stated in this specification document are intended to be excluded and do not form a part of this specification document.
- B. Electrical specifications and performance data contained in this specification document are based on Mini-Circuit's applicable established test performance criteria and measurement instructions.
- C. The parts covered by this specification document are subject to Mini-Circuits standard limited warranty and terms and conditions (collectively, "Standard Terms"); Purchasers of this part are entitled to the rights and benefits contained therein. For a full statement of the Standard Terms and the exclusive rights and remedies thereunder, please visit Mini-Circuits' website at [www.minicircuits.com/MCLStore/terms.jsp](http://www.minicircuits.com/MCLStore/terms.jsp)



## Typical Performance Data

FREQUENCY (MHz)	INSERTION LOSS Control @ 0V/-5V (dB) IN-OUT , "ON"	ISOLATION Control @ 0V/-5V (dB) IN-OUT , "OFF"	VSWR (:1)		
			IN	OUT , "ON"	OUT , "OFF"
3	0.54	83.44	1.12	1.12	16.46
5	0.54	83.46	1.12	1.12	16.21
10	0.54	81.44	1.12	1.12	16.21
20	0.61	76.29	1.12	1.12	16.04
50	0.59	69.27	1.12	1.12	15.37
100	0.62	66.59	1.12	1.12	14.63
200	0.65	61.43	1.12	1.12	14.00
500	0.70	53.61	1.13	1.13	12.83
912	0.75	47.64	1.14	1.15	11.86
1000	0.76	46.91	1.14	1.16	11.79
1581	0.92	41.27	1.22	1.20	11.85
2107	0.92	37.77	1.36	1.21	11.91
2370	0.88	37.33	1.37	1.26	9.64
2490	1.01	36.86	1.41	1.34	9.98
2753	1.17	35.65	1.51	1.42	9.70
3279	1.15	33.10	1.53	1.39	13.14
3805	1.16	33.46	1.50	1.35	13.37
4331	0.87	31.99	1.31	1.24	15.41
4474	0.70	32.16	1.23	1.23	17.84
4600	1.08	32.78	1.13	1.16	14.40

## Typical Performance Curves

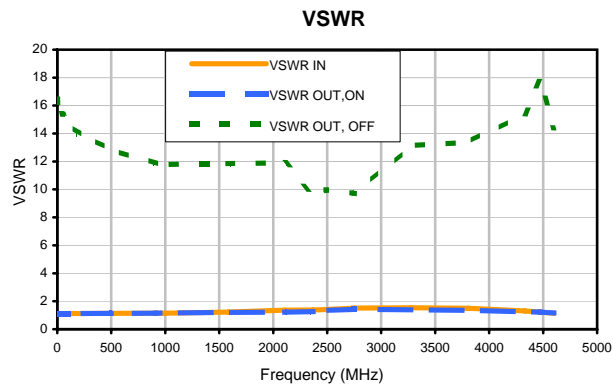
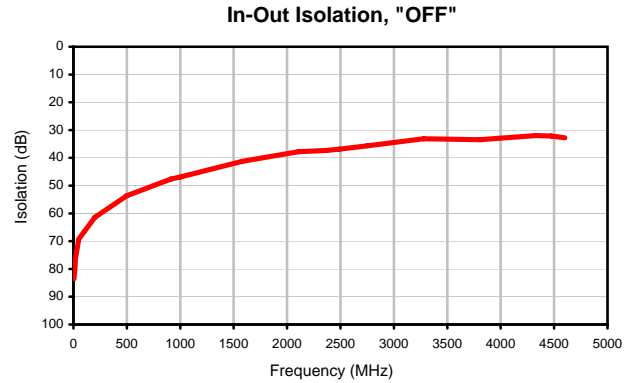
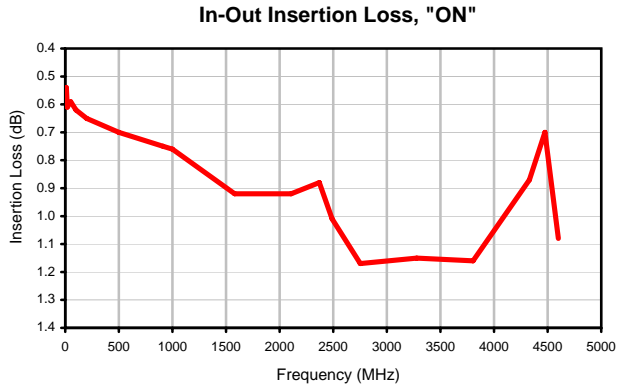

### Outline Dimensions

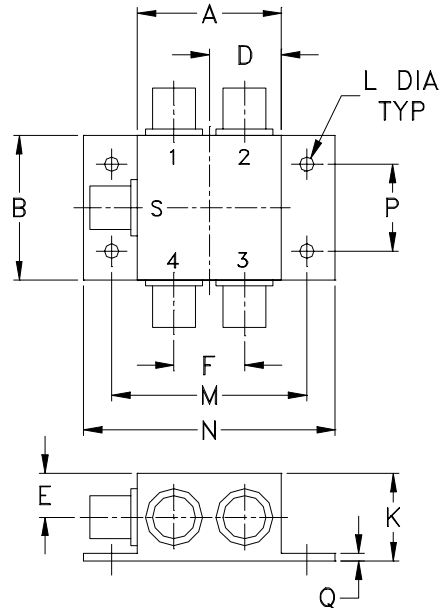

CASE #	A	B	C	D	E	F	G	H	J	K	L
G144	1.25 (31.75)	1.25 (31.75)	-- --	.63 (16.00)	.38 (9.65)	.61 (15.49)	-- --	-- --	-- --	.76 (19.30)	.125 (3.18)

CASE #	M	N	P	Q	WT. GRAM
G144	1.688 (42.88)	2.18 (55.37)	.75 (19.05)	.07 (1.78)	85.0

Dimensions are in inches (mm). Tolerances: 2Pl.  $\pm .03$ ; 3 Pl.  $\pm .015$

#### Notes:

1. Case material: Aluminum alloy.
2. Case finish:  
For RoHS Case Styles: Clear chemical conversion coating, non-chrome or trivalent chrome based.
3. Bracket version only.



INTERNET <http://www.minicircuits.com>

P.O. Box 350166, Brooklyn, New York 11235-0003 (718) 934-4500 Fax (718) 332-4661

Distribution Centers NORTH AMERICA 800-654-7949 • 417-335-5935 • Fax 417-335-5945 • EUROPE 44-1252-832600 • Fax 44-1252-837010

Mini-Circuits ISO 9001 & ISO 14001 Certified



All Mini-Circuits products are manufactured under exacting quality assurance and control standards, and are capable of meeting published specifications after being subjected to any or all of the following physical and environmental test.

Specification	Test/Inspection Condition	Reference/Spec
Operating Temperature	-55° to 100°C Ambient Environment	Individual Model Data Sheet
Storage Temperature	-55° to 150°C Ambient Environment	Individual Model Data Sheet
Barometric Pressure	100,000 Feet	MIL-STD-202, Method 105, Condition D
Humidity	90% RH, 65°C Units may require bake-out after humidity to restore full performance.	MIL-STD-202, Method 103
Thermal Shock	-65° to 125°C, 5 cycles	MIL-STD-202, Method 107, Condition B
Vibration (High Frequency)	20g peak, 10-2000 Hz, 12 times in each of three perpendicular directions (total 36)	MIL-STD-202, Method 204, Condition D
Mechanical Shock	100g, 6ms sawtooth, 3 shocks each direction 3 axes (total 18)	MIL-STD-202, Method 213, Condition I