

Coaxial Diplexer

ZDPL-2025-75-F+

75Ω DC to 1700 MHz
(DC - 204, 258-1700 MHz)



Generic photo used for illustration purposes only
CASE STYLE: F2239

The Big Deal

- Low insertion loss, 1dB typical
- High rejection
- High crossover isolation
- Excellent return loss, 24dB typical
- 75Ω Impedance
- Used in DOCSIS 3.1 standard test systems with extended range

Product Overview

ZDPL-2025-75-F+ is a high performance diplexer with the lowpass port at DC - 204 MHz and highpass port at 258-1700 MHz. Excellent return loss over extended frequency combined with high out of channel rejection makes it a ideal component in DOCSIS 3.1 test equipments, cable TV and multiband radio systems.

Key Features

Feature	Advantages
Low passband insertion loss	Passband insertion loss 1 dB ensures low signal loss through the both channels.
Excellent stopband rejection	Co-channel rejection of 50 dB typical ensures unwanted spurious are eliminated
Excellent return loss at DC-204 and 258-1700 MHz	This makes signal transmission with less reflections and well- matched with the adjacent component used in the system.

Notes

- A. Performance and quality attributes and conditions not expressly stated in this specification document are intended to be excluded and do not form a part of this specification document.
B. Electrical specifications and performance data contained in this specification document are based on Mini-Circuit's applicable established test performance criteria and measurement instructions.
C. The parts covered by this specification document are subject to Mini-Circuits standard limited warranty and terms and conditions (collectively, "Standard Terms"); Purchasers of this part are entitled to the rights and benefits contained therein. For a full statement of the Standard Terms and the exclusive rights and remedies thereunder, please visit Mini-Circuits' website at www.minicircuits.com/MCLStore/terms.jsp



Coaxial Diplexer

ZDPL-2025-75-F+

75Ω DC to 1700 MHz (DC-204, 258-1700 MHz)

Maximum Ratings

Operating Temperature	-40°C to 85°C
Storage Temperature	-55°C to 100°C
RF Power Input	30 dBm Max.

Permanent damage may occur if any of these limits are exceeded.

Coaxial Connections

HIGH PASS PORT	3
LOW PASS PORT	2
COMMON PORT	1

Features

- Low insertion loss
- Excellent return loss
- High rejection
- High cross over isolation
- 75Ω impedance

Applications

- Cable TV and Multiband radio systems
- DOCSIS 3.1 test system with extended range



Generic photo used for illustration purposes only

CASE STYLE: F2239
 Connectors Model
 F-Female ZDPL-2025-75-F+
 BRACKET (OPTION "B")

+RoHS Compliant

The +Suffix identifies RoHS Compliance. See our web site for RoHS Compliance methodologies and qualifications

Outline Drawing

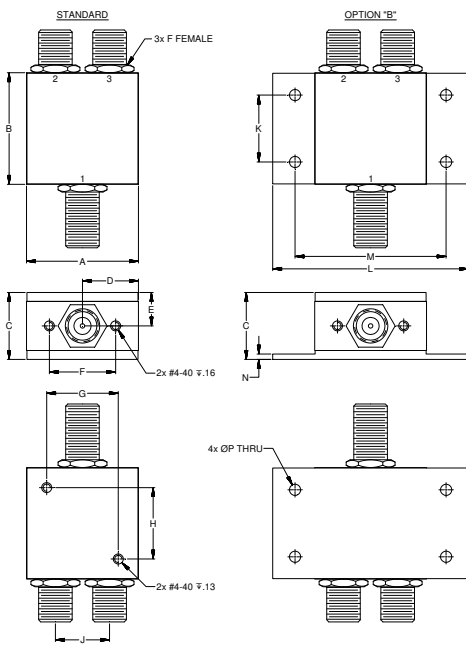

Outline Dimensions (inch/mm)

A	B	C	D	E	F	G	H
1.25	1.25	.75	.63	.38	.74	.80	.80
31.75	31.75	19.05	15.88	9.53	18.80	20.32	20.32
J	K	L	M	N	P		Wt.
.61	.75	2.19	1.69	.06	.125		grams
15.37	19.05	55.58	42.88	1.52	3.18		85

Note: Please refer to case style drawing for details

Electrical Specifications at 25°C

Parameter	Port	Frequency (MHz)	Min.	Typ.	Max.	Unit	
Pass Band	Insertion Loss	Low Pass	DC-204	-	1	1.5	dB
		High Pass	258-1700	-	1	1.5	
	Return Loss	Low Pass	DC-204	20	24	-	dB
		High Pass	258-1400	18	23	-	
		High Pass	1400-1700	15	20	-	
		Common	DC-204	20	24	-	
Stop Band Isolation	Low Pass	258-1700	45	65	-	dB	
	High Pass	DC-204	42	50	-		
Cross Over Isolation	LP-HP	204-258	33	37	-	dB	

Typical Performance Data at 25°C

FREQUENCY (GHz)	INSERTION LOSS (dB)			RETURN LOSS (dB)	
	Low Pass Port	High Pass Port	Common Port	Low Pass Port	High Pass Port
1	0.02	91.75	51.55	51.27	0.01
10	0.06	81.26	40.90	41.37	0.00
50	0.14	70.19	32.68	36.85	0.02
100	0.24	67.37	29.74	30.10	0.08
204	0.96	47.79	33.08	30.67	0.60
206	1.03	47.05	36.03	35.22	0.62
219	3.06	42.34	8.00	7.28	0.80
225	8.07	30.57	3.36	2.49	0.97
226	9.17	28.41	3.03	2.14	1.00
230	14.18	20.75	2.35	1.30	1.21
234	20.07	14.24	2.39	0.95	1.66
240	30.36	7.07	4.01	0.74	3.50
241	33.89	5.62	5.01	0.71	4.50
245	44.01	3.03	9.29	0.65	8.62
250	50.80	1.73	18.37	0.60	16.30
258	56.49	1.16	29.49	0.53	24.91
300	58.15	0.58	22.91	0.37	23.76
500	85.33	0.31	28.36	0.17	28.82
1000	71.22	0.37	24.53	0.24	24.07
1400	64.53	0.42	30.37	0.36	29.77
1600	63.97	0.45	26.63	0.48	31.39
1700	63.05	0.50	21.71	0.58	24.22

Functional Schematic

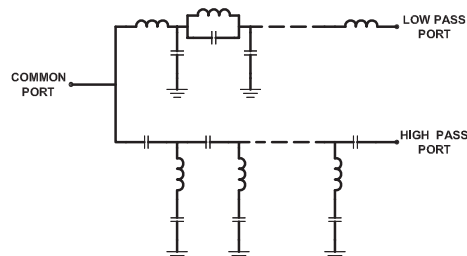

Notes

- Performance and quality attributes and conditions not expressly stated in this specification document are intended to be excluded and do not form a part of this specification document.
- Electrical specifications and performance data contained in this specification document are based on Mini-Circuits' applicable established test performance criteria and measurement instructions.
- The parts covered by this specification document are subject to Mini-Circuits standard limited warranty and terms and conditions (collectively, "Standard Terms"); Purchasers of this part are entitled to the rights and benefits contained therein. For a full statement of the Standard Terms and the exclusive rights and remedies thereunder, please visit Mini-Circuits' website at www.minicircuits.com/MCLStore/terms.jsp



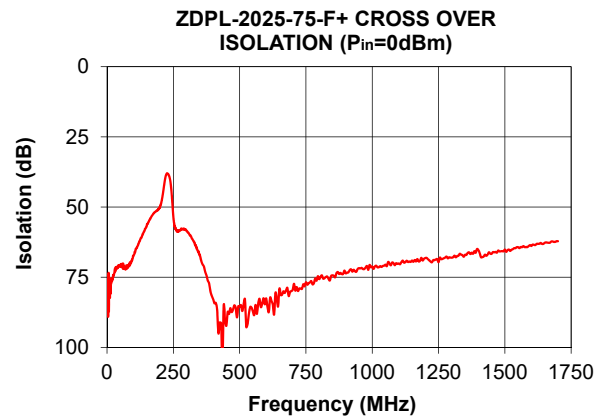
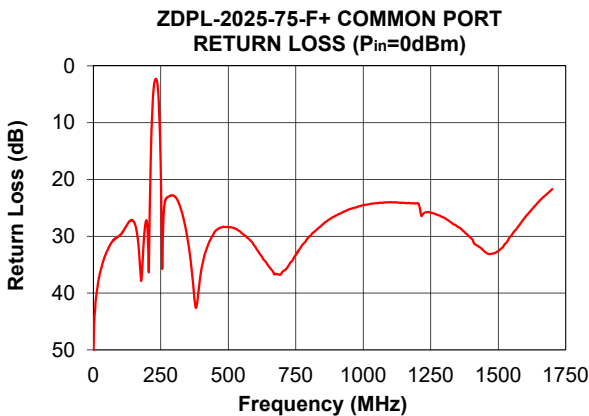
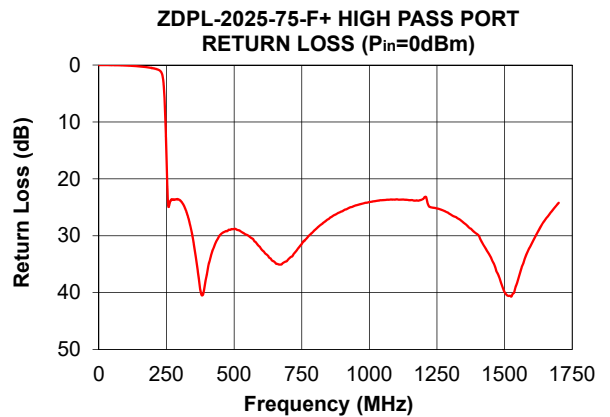
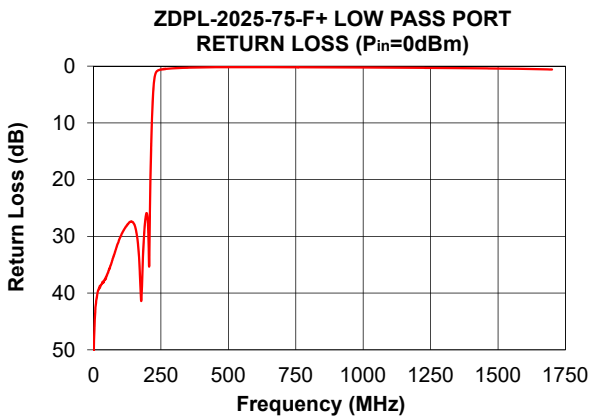
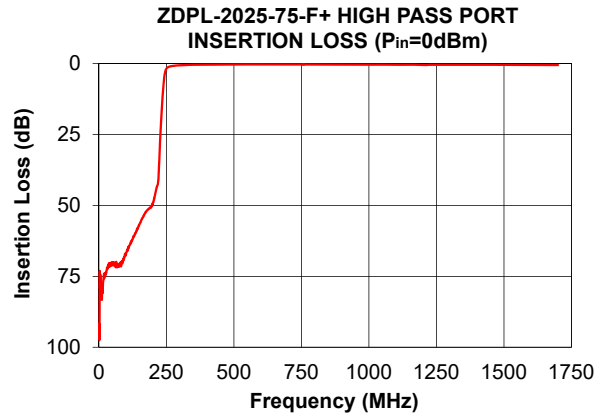
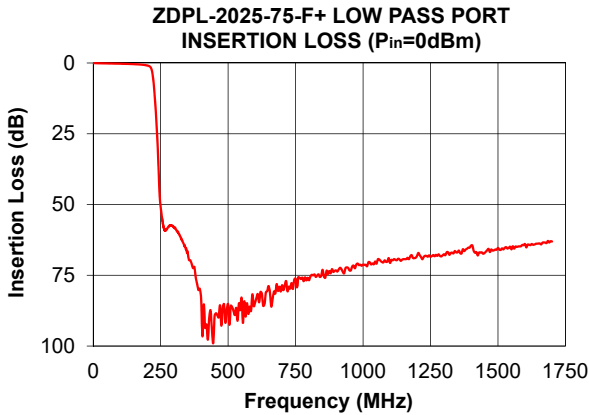

Notes

- A. Performance and quality attributes and conditions not expressly stated in this specification document are intended to be excluded and do not form a part of this specification document.
- B. Electrical specifications and performance data contained in this specification document are based on Mini-Circuit's applicable established test performance criteria and measurement instructions.
- C. The parts covered by this specification document are subject to Mini-Circuits standard limited warranty and terms and conditions (collectively, "Standard Terms"); Purchasers of this part are entitled to the rights and benefits contained therein. For a full statement of the Standard Terms and the exclusive rights and remedies thereunder, please visit Mini-Circuits' website at www.minicircuits.com/MCLStore/terms.jsp



Typical Performance Data

FREQUENCY (GHz)	INSERTION LOSS (dB)		Cross over isolation (dB) (between LPF and HPF)	RETURN LOSS (dB)		
	Lowpass port	Highpass port		Common port	Lowpass port	Highpass port
1.00	0.02	91.75	82.11	51.55	51.27	0.01
10.00	0.06	81.26	80.19	40.90	41.37	0.00
50.00	0.14	70.19	70.88	32.68	36.85	0.02
100.00	0.24	67.37	67.16	29.74	30.10	0.08
125.00	0.31	61.78	61.55	28.00	28.01	0.15
150.00	0.40	56.65	56.53	27.41	27.78	0.24
175.00	0.53	52.20	52.35	36.75	40.12	0.36
200.00	0.87	49.19	49.84	28.12	26.49	0.55
204.00	0.96	47.79	48.66	33.08	30.67	0.60
205.00	1.00	47.38	48.28	35.34	33.00	0.61
206.00	1.03	47.05	47.79	36.03	35.22	0.62
210.00	1.23	45.23	45.69	22.86	22.91	0.67
218.00	2.83	42.58	40.51	8.58	7.87	0.79
218.50	3.06	42.34	40.25	8.00	7.28	0.80
222.00	5.26	37.42	38.75	4.89	4.08	0.87
225.00	8.07	30.57	38.15	3.36	2.49	0.97
228.00	11.56	24.40	38.07	2.58	1.63	1.09
229.00	12.85	22.53	38.13	2.44	1.44	1.15
230.00	14.18	20.75	38.21	2.35	1.30	1.21
231.00	15.57	19.03	38.35	2.29	1.18	1.29
232.00	17.01	17.37	38.48	2.28	1.09	1.39
233.00	18.51	15.78	38.67	2.31	1.01	1.51
234.00	20.07	14.24	38.89	2.39	0.95	1.66
236.00	23.44	11.36	39.50	2.70	0.85	2.09
238.00	27.20	8.77	40.39	3.31	0.78	2.76
239.00	29.28	7.61	40.96	3.75	0.75	3.23
239.50	30.36	7.07	41.28	4.01	0.74	3.50
241.00	33.89	5.62	42.48	5.01	0.71	4.50
242.00	36.39	4.80	43.37	5.85	0.70	5.33
245.00	44.01	3.03	46.90	9.29	0.65	8.62
246.00	46.10	2.64	48.21	10.75	0.64	9.97
258.00	56.49	1.16	57.66	29.49	0.53	24.91
300.00	58.15	0.58	58.46	22.91	0.37	23.76
350.00	66.89	0.41	67.11	30.71	0.27	31.19
400.00	83.04	0.34	82.77	35.91	0.22	36.59
450.00	89.33	0.32	92.26	29.20	0.19	29.78
500.00	85.33	0.31	85.53	28.36	0.17	28.82
650.00	78.82	0.30	79.07	35.32	0.18	34.63
700.00	78.51	0.31	79.51	36.29	0.18	34.16
750.00	76.16	0.31	76.82	33.29	0.19	31.44
800.00	76.73	0.32	75.67	30.03	0.19	28.93
850.00	73.07	0.33	74.33	27.89	0.20	27.04
900.00	73.29	0.35	73.60	26.34	0.21	25.70
950.00	73.29	0.36	71.78	25.20	0.22	24.66
1000.00	71.22	0.37	71.23	24.53	0.24	24.07
1100.00	70.62	0.39	70.11	24.00	0.26	23.60
1150.00	69.29	0.39	69.07	24.11	0.27	23.76
1200.00	68.14	0.43	68.18	24.18	0.29	23.48
1220.00	69.31	0.43	69.46	26.16	0.30	24.81
1300.00	67.59	0.41	68.04	26.74	0.32	26.23
1350.00	66.89	0.41	67.00	28.33	0.34	27.77
1400.00	64.53	0.42	65.35	30.37	0.36	29.77
1450.00	67.13	0.42	66.66	32.71	0.39	33.87
1500.00	65.35	0.43	65.16	32.57	0.42	39.90
1550.00	65.82	0.44	64.31	29.77	0.45	37.73
1600.00	63.97	0.45	63.85	26.63	0.48	31.39
1650.00	63.76	0.47	62.76	23.92	0.53	27.20
1670.00	63.38	0.48	62.71	22.97	0.55	25.95
1680.00	63.60	0.49	62.26	22.57	0.56	25.36
1700.00	63.05	0.50	62.17	21.71	0.58	24.22

Coaxial Diplexer

ZDPL-2025-75-F+

Typical Performance Curves

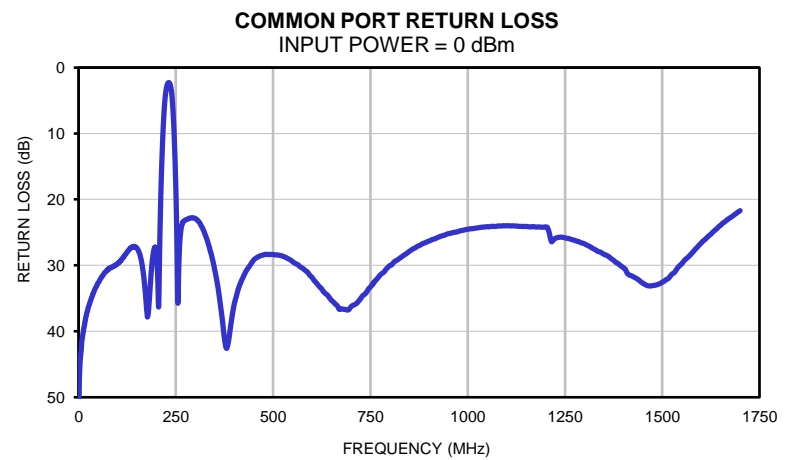
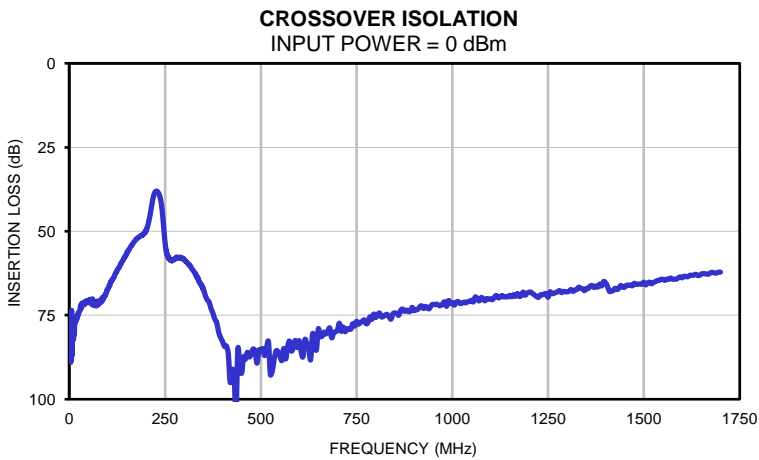
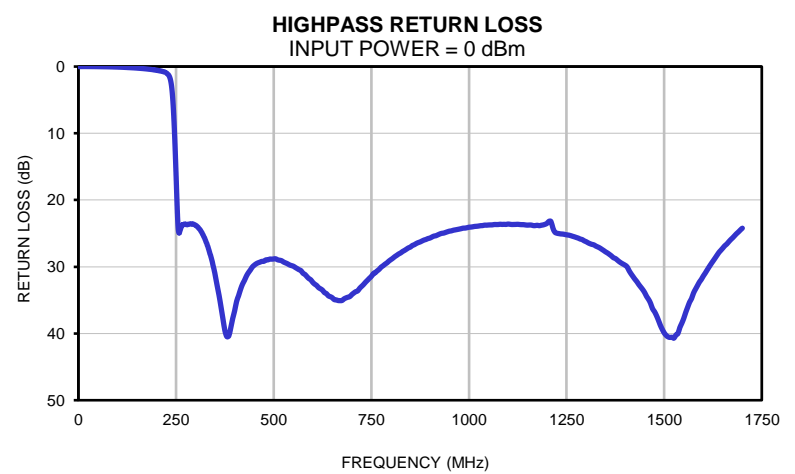
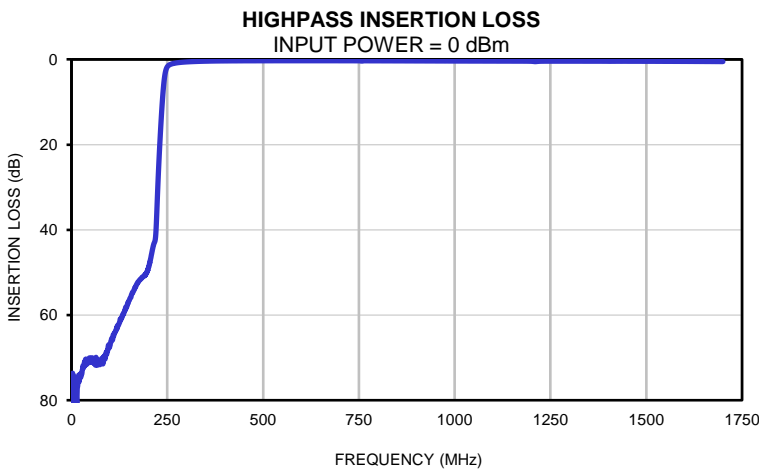
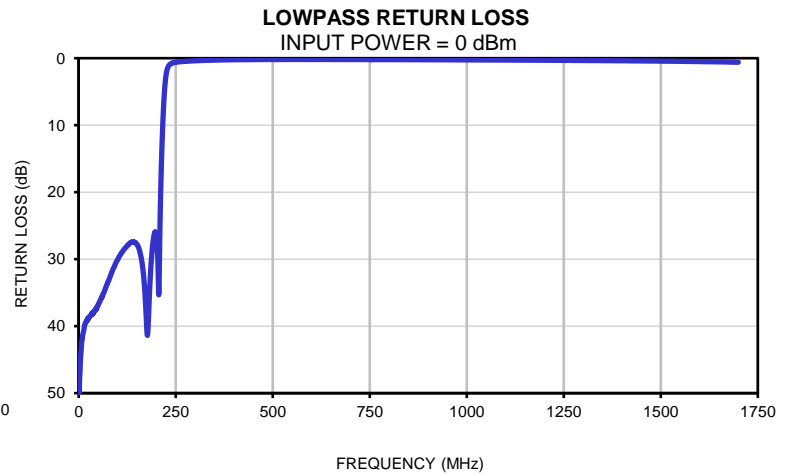
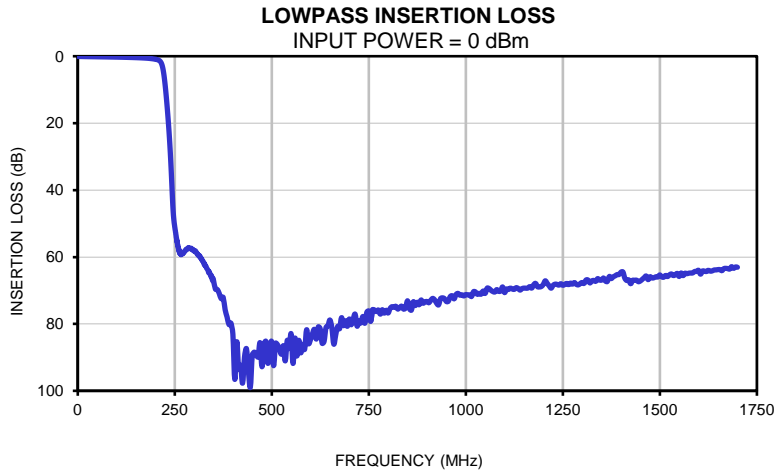

P.O. Box 350166, Brooklyn, New York 11235-0003 (718) 934-4500 • Fax (718) 332-4661 For detailed performance specs & shopping online see Mini-Circuits web site
The Design Engineers Search Engine Provides ACTUAL Data Instantly From MINI-CIRCUITS At: www.minicircuits.com



IF/RF MICROWAVE COMPONENTS

REV. OR
ZDPL-2025-75-F+
161205
Page 1 of 1

Outline Dimensions

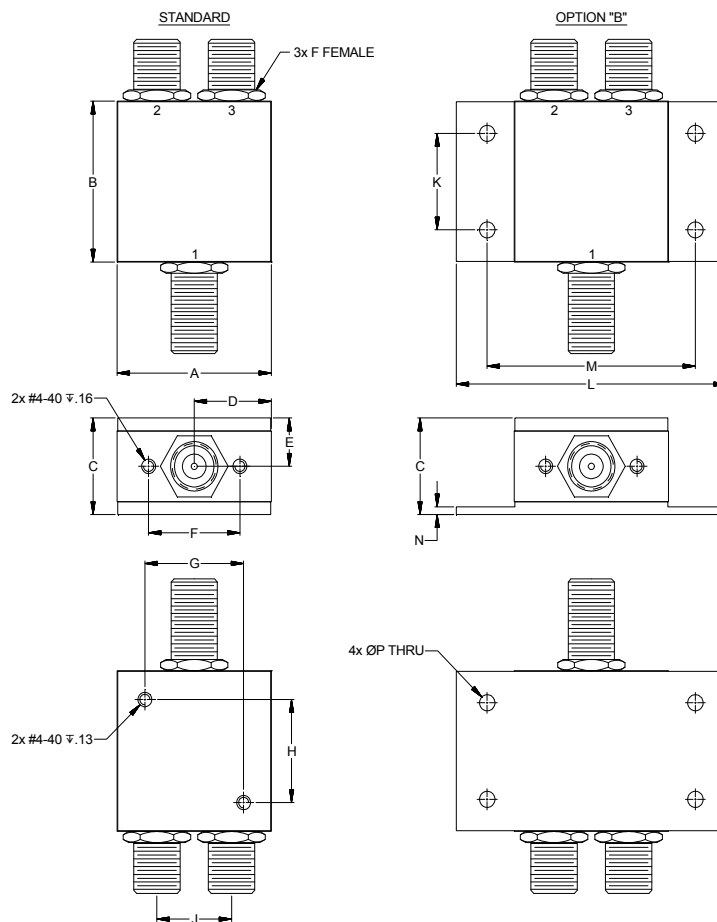

CASE#	A	B	C	D	E	F	G	H	J
F2239	1.25 (31.75)	1.25 (31.75)	.75 (19.05)	.63 (15.88)	.38 (9.53)	.74 (18.80)	.80 (20.32)	.80 (20.32)	.61 (15.37)

CASE#	K	L	M	N	P	WT.GRAMS
F2239	.75 (19.05)	2.19 (55.58)	1.69 (42.88)	.06 (1.52)	.125 (3.18)	85

Dimensions are in inches (mm). Tolerances: 2Pl. \pm .03; 3Pl. \pm .015

Notes:

- Case material: Aluminum alloy.
- Case finish:
 - For RoHS Case Styles: Clear chemical conversion coating, non-chrome or trivalent chrome based.
- Mounting bracket available on request: Add suffix B to part number.
- For Bracket version, option "B" dimension "C" changes from .76 to 1.00 inches when connectors type change.
- Refer to the individual model sheet for the type of connectors available.



INTERNET <http://www.minicircuits.com>

P.O. Box 350166, Brooklyn, New York 11235-0003 (718) 934-4500 Fax (718) 332-4661

Distribution Centers NORTH AMERICA 800-654-7949 • 417-335-5935 • Fax 417-335-5945 • EUROPE 44-1252-832600 • Fax 44-1252-837010

Mini-Circuits ISO 9001 & ISO 14001 Certified

All Mini-Circuits products are manufactured under exacting quality assurance and control standards, and are capable of meeting published specifications after being subjected to any or all of the following physical and environmental test.

Specification	Test/Inspection Condition	Reference/Spec
Operating Temperature	-55° to 100°C Ambient Environment	Individual Model Data Sheet
Storage Temperature	-55° to 100° C Ambient Environment	Individual Model Data Sheet
Humidity	90 to 95% RH, 40°C, 96 hours; Units may require bake-out after humidity to restore full performance.	MIL-STD-202, Method 103, Condition B
Thermal Shock	-55° to 100°C, 100 cycles	MIL-STD-202, Method 107, Condition A-3, except +100°C
Vibration (High Frequency)	20g peak, 10-2000 Hz, 12 times in each of three perpendicular directions (total 36)	MIL-STD-202, Method 204, Condition D
Mechanical Shock	50g, 11ms half-sine, 3 shocks each direction 3 axes (total 18)	MIL-STD-202, Method 213, Condition A