

Ceramic

LTCC Bandpass Filter

BPNL-1891+

50Ω 1790 to 2000 MHz

The Big Deal

- Small size 2.5mm x 2.0mm
- Low loss in passband (2.6 dB typ)
- Very high rejection over wide band



CASE STYLE: NL1008C-3

Product Overview

The BPNL-1891+ LTCC bandpass filter achieves a miniature size and high repeatability of performance. Wrap-around terminations minimize variations in performance due to parasitics. Passing 1790-2000 MHz, these units offer excellent rejection over a wide stopband.

Key Features

Feature	Advantages
Small Size (2.5mm x2.0 mm)	Allows for high layout density of circuit boards, while minimizing effects of parasitics.
Transmission zero at 2nd harmonic within wide stopband	Provides good rejection of harmonic signals, for improved system performance.
Wrap around termination	Provides excellent solderability and easy visual inspection capability.
LTCC construction	Provides a rugged package that is well suited for tough environments including high humidity and high temperature extremes.

Ceramic LTCC Bandpass Filter

50Ω 1790 to 2000 MHz

BPNL-1891+



Generic photo used for illustration purposes only

CASE STYLE: NL1008C-3

+RoHS Compliant

The +Suffix identifies RoHS Compliance. See our web site for RoHS Compliance methodologies and qualifications

Features

- Small size
- Temperature stable
- Hermetically sealed
- LTCC construction
- Wide stopband

Applications

- Harmonic Rejection
- Transmitters / Receivers
- Test and Measurement

Electrical Specifications at 25°C

Parameter	Frequency (MHz)	Min.	Typ.	Max.	Unit
Pass Band	Center Frequency	—	1890	—	MHz
	Insertion Loss	1790 - 2000	2.6	3.5	dB
	VSWR	1790 - 2000	1.5	—	:1
Stop Band, Lower	Insertion Loss	DC - 1090	27	36	dB
Stop Band, Upper	Insertion Loss	2615 - 5935	27	33	dB

1. Measured on Mini-Circuits Characterization Test Board TB-1086+ with feedline losses removed using Auto Port Extension feature of VNA.

2. This filter is not intended for use as a DC Blocking circuit element. In Application where DC voltage is present at either input or output ports, blocking capacitors are required at the corresponding RF port.

Maximum Ratings

Operating Temperature	-55°C to +100°C
Storage Temperature	-55°C to +100°C
RF Power Input*	1W at 25°C

*Passband rating, derate linearly to 0.5W at 100°C ambient
Permanent damage may occur if any of these limits are exceeded.

Typical Performance Data at 25°C

Frequency (GHz)	Insertion Loss (dB)	VSWR (:1)
400	-38.36	459.57
600	-36.61	205.12
1200	-30.84	43.55
1500	-12.33	12.42
1700	-3.01	1.61
1750	-2.41	1.12
1900	-2.23	1.33
2000	-2.40	1.33
2100	-2.91	1.53
2600	-36.41	16.66
3500	-39.59	9.71
4500	-43.01	16.95
5000	-38.75	8.65
6000	-35.56	16.38
7000	-27.84	35.08

Top View

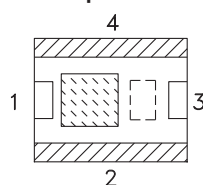

Pad Connections

Input	1
Output	3
Ground	2,4

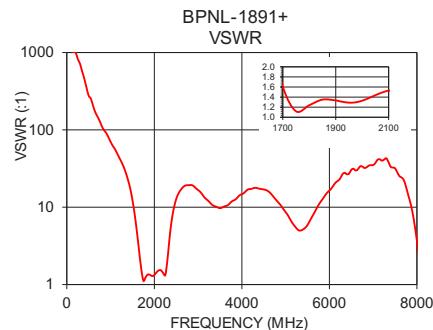
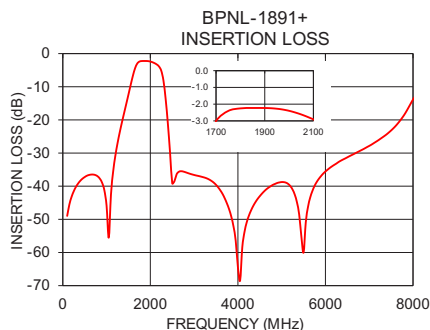

Outline Drawing

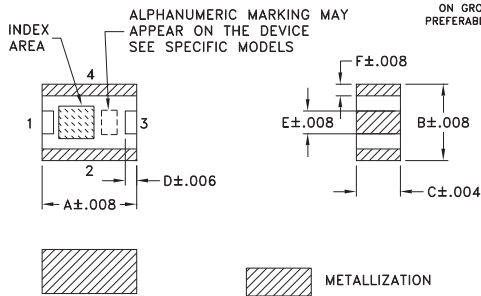

PCB Land Pattern

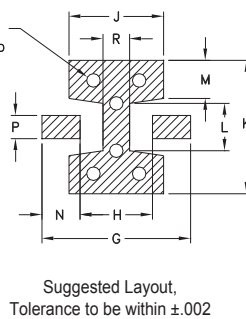

Demo Board MCL P/N: TB-1086+ Suggested PCB Layout (PL-617)

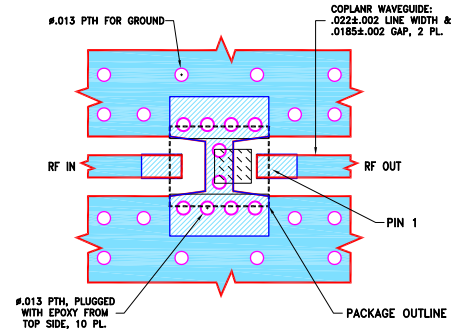

- NOTES:
- COPLANAR WAVEGUIDE PARAMETERS ARE SHOWN FOR ROGERS R04350B WITH DIELECTRIC THICKNESS .010±.001, COPPER: 1/2 OZ. EACH SIDE. FOR OTHER MATERIALS LINE WIDTH & GAP MAY NEED TO BE MODIFIED.
 - BOTTOM SIDE OF THE PCB IS CONTINUOUS GROUND PLANE.
- DENOTES PCB COPPER LAYOUT WITH SMOBC (SOLDER MASK OVER BARE COPPER).
- DENOTES COPPER LAND PATTERN FREE OF SOLDER MASK.

Product Marking: KW

Outline Dimensions ($\frac{\text{inch}}{\text{mm}}$)

A	B	C	D	E	F	G	H	J
.098	.079	.046	.012	.024	.012	.154	.075	.098
2.49	2.01	1.17	0.30	0.61	0.30	3.91	1.91	2.49
K	L	M	N	P	Q	R	wt	
.138	.055	.041	0.039	0.024	0.014	0.028	grams	
3.51	1.40	1.04	0.99	0.61	0.36	0.71	.019	

Additional Notes

- Performance and quality attributes and conditions not expressly stated in this specification document are intended to be excluded and do not form a part of this specification document.
- Electrical specifications and performance data contained in this specification document are based on Mini-Circuit's applicable established test performance criteria and measurement instructions.
- The parts covered by this specification document are subject to Mini-Circuits standard limited warranty and terms and conditions (collectively, "Standard Terms"); Purchasers of this part are entitled to the rights and benefits contained therein. For a full statement of the Standard Terms and the exclusive rights and remedies thereunder, please visit Mini-Circuits' website at www.minicircuits.com/MCLStore/terms.jsp

FREQUENCY (MHz)	INSERTION LOSS (dB)	VSWR (:1)
100	48.97	1123.66
200	43.23	1008.23
300	40.20	719.63
400	38.36	459.57
500	37.25	275.83
600	36.61	205.12
700	36.50	149.08
800	37.06	111.50
900	39.04	91.31
1000	45.89	70.29
1100	42.59	56.32
1200	30.84	43.55
1300	23.78	33.13
1400	17.95	22.37
1500	12.33	12.42
1600	6.74	4.92
1650	4.45	2.78
1700	3.01	1.61
1720	3.01	1.61
1740	3.01	1.61
1760	2.41	1.12
1780	2.41	1.12
1800	2.25	1.24
1820	2.25	1.24
1840	2.25	1.24
1860	2.23	1.35
1880	2.23	1.35
1900	2.23	1.33
1920	2.24	1.31
1940	2.26	1.29
1960	2.29	1.29
1980	2.34	1.30
2000	2.40	1.33
2020	2.48	1.37
2040	2.57	1.41
2060	2.67	1.46
2080	2.79	1.50
2100	2.91	1.53
2120	2.91	1.53
2140	2.91	1.53
2160	3.31	1.53
2180	3.31	1.53
2200	3.93	1.41
2220	3.93	1.41
2240	3.93	1.41
2260	5.20	1.32
2280	5.20	1.32
2300	8.21	2.10
2400	21.14	6.95
2600	36.41	16.66
2800	35.78	19.275
3000	36.61	16.68
3500	39.59	9.71
4000	64.43	14.75
4500	43.01	16.95
5000	38.75	8.65
5500	60.02	5.89
6000	35.56	16.38
6500	31.29	30.44
7000	27.84	35.08
7500	23.19	31.89
8000	13.85	3.69
8500	21.97	16.46
9000	31.21	36.35
9500	39.65	32.49
10000	32.29	20.56

Typical Performance Curves

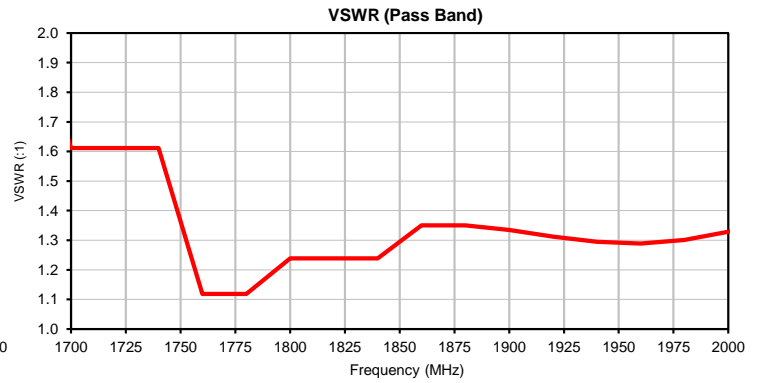
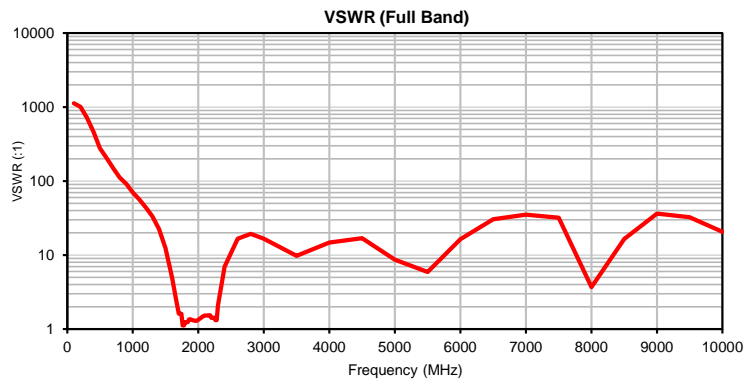
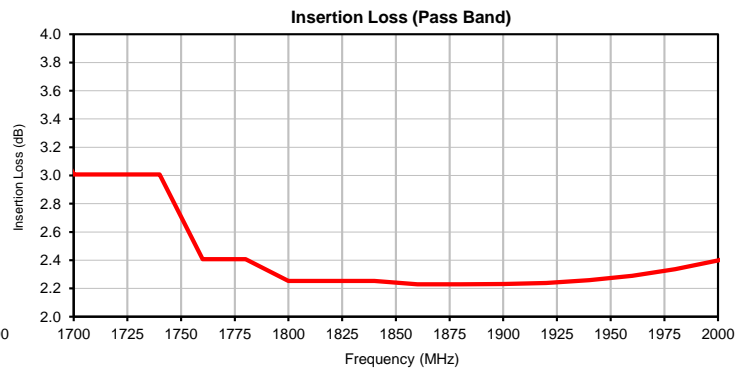
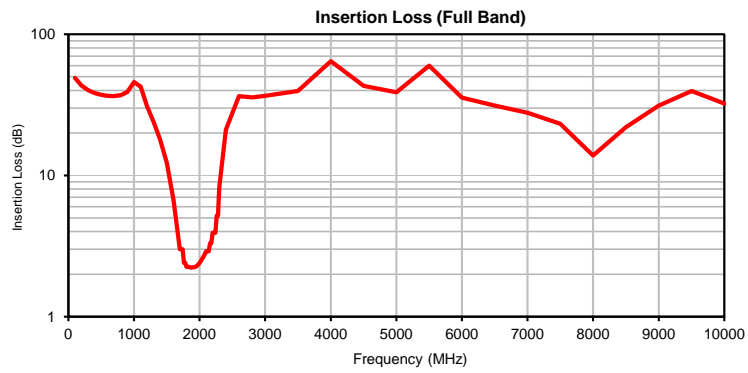

P.O. Box 350166, Brooklyn, New York 11235-0003 (718) 934-4500 • Fax (718) 332-4661 For detailed performance specs & shopping online see Mini-Circuits web site
The Design Engineers Search Engine Provides ACTUAL Data Instantly From MINI-CIRCUITS At: www.minicircuits.com



IF/RF MICROWAVE COMPONENTS

Outline Dimensions

NL1008C-3

PCB Land Pattern

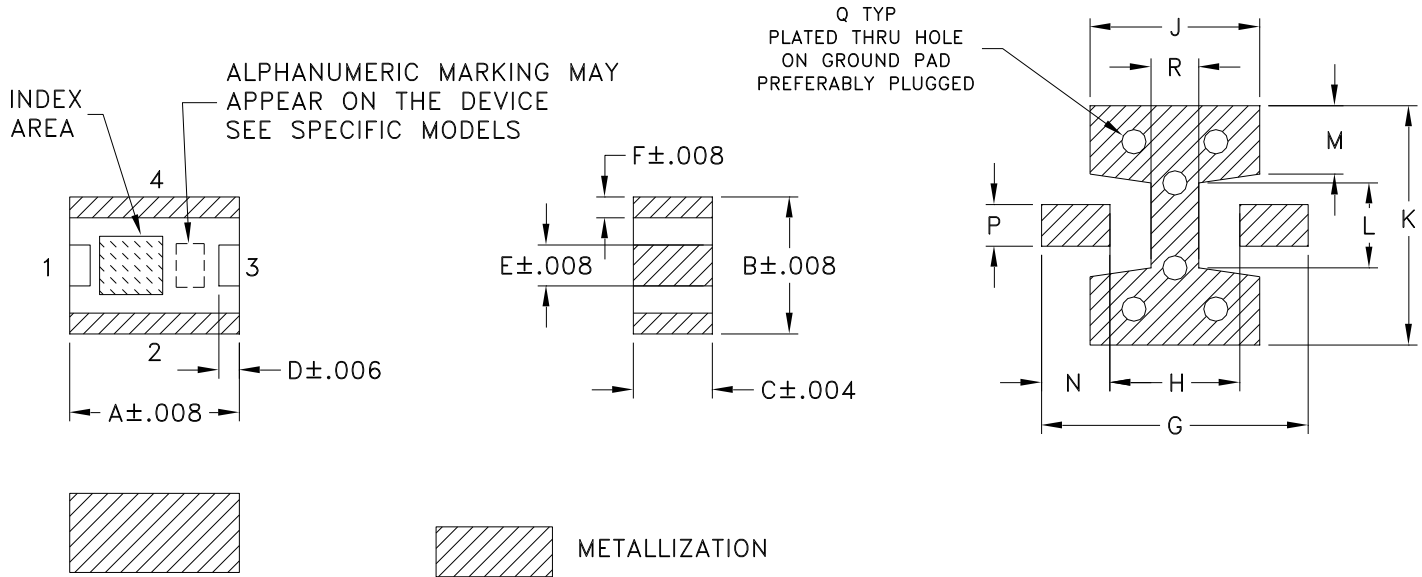

Suggested Layout,
Tolerance to be within $\pm .002$

CASE #	A	B	C	D	E	F	G	H	J	K	L	M	N
NL1008C-3	.098 (2.50)	.079 (2.00)	.046 (1.16)	.012 (0.30)	.024 (0.60)	.012 (0.30)	.154 (3.90)	.075 (1.90)	.098 (2.50)	.138 (3.50)	.055 (1.40)	.041 (1.05)	.039 (1.00)

CASE #	P	Q	R	WT. GRAM
NL1008C-3	.024 (0.60)	.014 (0.35)	.028 (0.70)	.019

Dimensions are in inches (mm). Tolerances: 2 Pl. $\pm .01$; 3 Pl. $\pm .005$

Notes:

- Open style, ceramic base.
- Termination finish:
For RoHS Case Styles: Tin plate over Nickel plate. All models, (+) suffix.
For RoHS-5 Case Styles: Tin-Lead plate. All models, no (+) suffix.
- Pad tolerance is non-cumulative. Minimum spacing between each pad is .004.
- Line width should be designed to match 50Ω characteristic depending on PCB material and thickness.

Mini-Circuits®
ISO 9001 ISO 14001 CERTIFIED

ALL NEW
minicircuits.com

P.O. Box 350166, Brooklyn, New York 11235-0003 (718) 934-4500 Fax (718) 332-4661 For detailed performance specs & shopping online see Mini-Circuits web site



The Design Engineers Search Engine Provides ACTUAL Data Instantly From MINI-CIRCUITS At: www.minicircuits.com

RF/IF MICROWAVE COMPONENTS

THIRD ANGLE PROJECTION

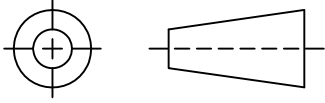

REVISIONS

REV	ECN No.	DESCRIPTION	DATE	DR	AUTH
OR	M175214	NEW RELEASE	07/10/19	ITG	BK

SUGGESTED MOUNTING CONFIGURATION
FOR NL1008C-3 CASE STYLE

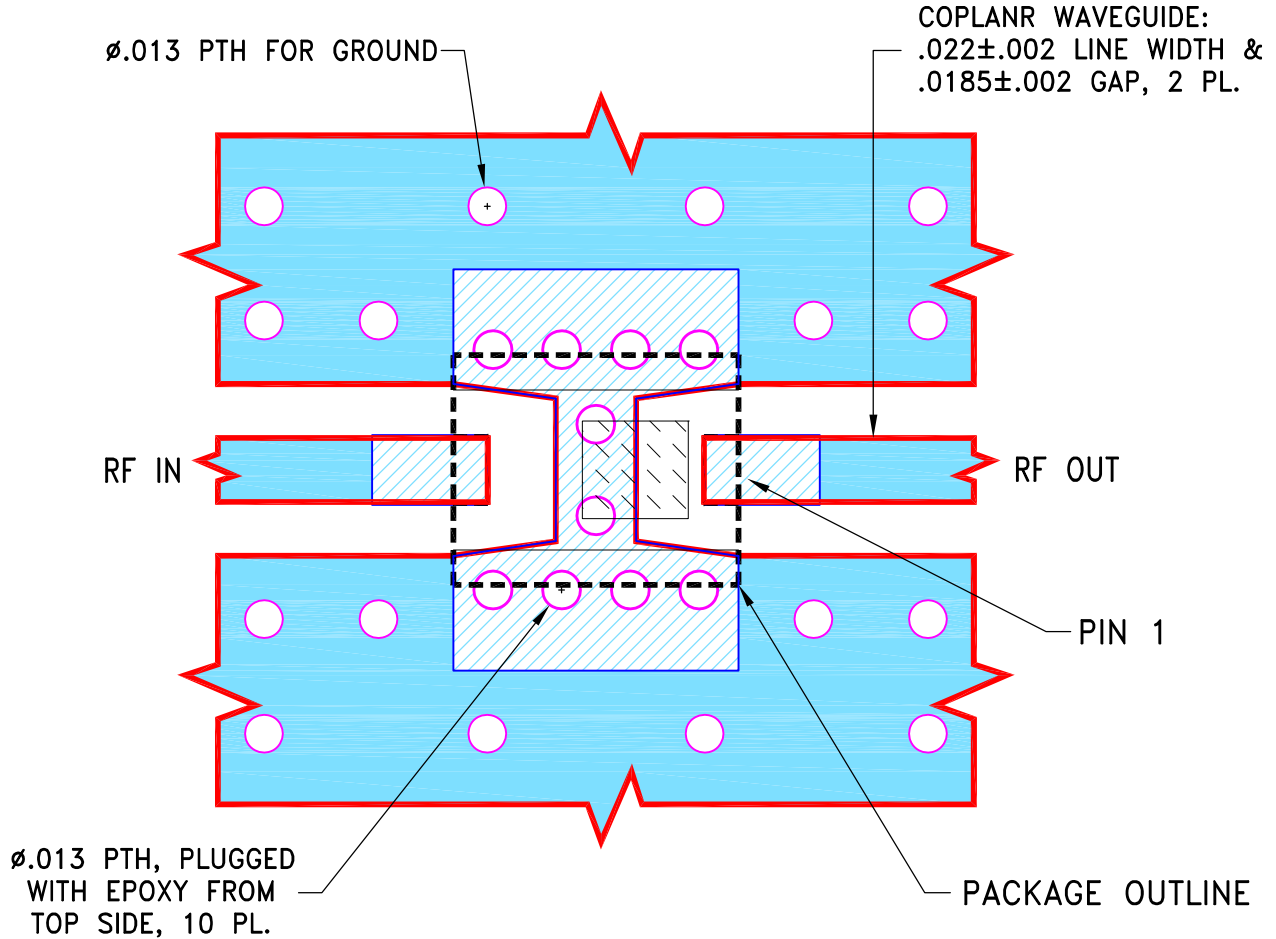

NOTES:

1. COPLANAR WAVEGUIDE PARAMETERS ARE SHOWN FOR ROGERS RO4350B WITH DIELECTRIC THICKNESS $.010 \pm .001$. COPPER: 1/2 OZ. EACH SIDE. FOR OTHER MATERIALS LINE WIDTH & GAP MAY NEED TO BE MODIFIED.
2. BOTTOM SIDE OF THE PCB IS CONTINUOUS GROUND PLANE.



DENOTES PCB COPPER LAYOUT WITH SMOBC (SOLDER MASK OVER BARE COPPER).

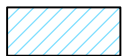

DENOTES COPPER LAND PATTERN FREE OF SOLDER MASK.

UNLESS OTHERWISE SPECIFIED	INITIALS	DATE
DIMENSIONS ARE IN INCHES	DRAWN ITG	07/09/19
TOLERANCES ON:	CHECKED GF	07/10/19
2 PL DECIMALS ±	APPROVED BK	07/10/19
3 PL DECIMALS ± .005		
ANGLES ±		
FRACTIONS ±		



Mini-Circuits®

13 Neptune Avenue
Brooklyn NY 11235

PL, NL1008C-3, TB-1086+

Mini-Circuits®
THIS DOCUMENT AND ITS CONTENTS ARE THE PROPERTY OF MINI-CIRCUITS. EXCEPT FOR USE EXPRESSLY GRANTED, IN WRITING, TO ITS VENDORS, VENDEE AND THE UNITED STATES GOVERNMENT, MINI-CIRCUITS RESERVES ALL PROPRIETARY DESIGN, USE, MANUFACTURING AND REPRODUCTION RIGHTS THERETO. THESE CONTENTS SHALL NOT BE USED, DUPLICATED OR DISCLOSED TO ANY OUTSIDE PARTY, IN WHOLE OR IN PART, WITHOUT WRITTEN PERMISSION OF MINI-CIRCUITS.

SIZE	CODE IDENT	DRAWING NO:	REV:
A	15542	98-PL-617	OR
FILE:	98PL617	SCALE: 15:1	SHEET: 1 OF 1

All Mini-Circuits products are manufactured under exacting quality assurance and control standards, and are capable of meeting published specifications after being subjected to any or all of the following physical and environmental test.

Specification	Test/Inspection Condition	Reference/Spec
Operating Temperature	-55° to 100°C Ambient Environment	Individual Model Data Sheet
Storage Temperature	-55° to 100° C Ambient Environment	Individual Model Data Sheet
Humidity	90 to 95% RH, 240 hours, 50°C	MIL-STD-202, Method 103, Condition A, Except 50°C and end-point electrical test done within 12 hours
Solder Reflow Heat	Sn-Pb Eutetic Process: 225°C peak Pb-Free Process 245° - 250°C peak	J-STD-020, Table 4-1, 4-2 and 5-2, Figure 5-1
Solderability	10X Magnification	J-STD-002, Para 4.2.5, Test S, 95% Coverage
Vibration (High Frequency)	20g peak, 10-2000 Hz, 12 times in each of three perpendicular directions (total 36)	MIL-STD-202, Method 204, Condition D
Mechanical Shock	50g, 11 ms, 1/2-sine, 18 shocks: 3 each direction, each of 3 axes	MIL-STD-202, Method 213, Condition A