

Coaxial

# Voltage Controlled Oscillator

## ZX95-3550+

5V Tuning for PLL IC's 3350 to 3550 MHz

### Features

- linear tuning characteristics
- low pushing
- low pulling
- protected by US patent 6,790,049

### Applications

- r & d
- lab
- instrumentation
- wireless communications
- WiMAX



CASE STYLE: GB956

Connectors	Model
SMA	ZX95-3550-S+

### +RoHS Compliant

The +Suffix identifies RoHS Compliance. See our web site for RoHS Compliance methodologies and qualifications

### Electrical Specifications

MODEL NO.	FREQ. (MHz)		POWER OUTPUT (dBm)	PHASE NOISE				TUNING					NON HARMONIC SPURIOUS (dBc)	HARMONICS (dBc)		PULLING pk-pk @ 12 dB Br (MHz)	PUSHING (MHz/V)	DC OPERATING POWER		
				dBc/Hz SSB at offset frequencies, kHz				VOLTAGE RANGE (V)	SENSI-TIVITY (MHz/V)	PORT CAP (pF)	3 dB MODULATION BANDWIDTH (MHz)	Typ.		Typ.	Typ.			Max.	Vcc (volts)	Current (mA)
				Typ.	1	10	100													
ZX95-3550+	3350	3550	+3	-71	-98	-119	-139	0.5	5	55-85	17	110	-90	-23	-13	1	1.5	5	42	

### Maximum Ratings

Operating Temperature	-55°C to 85°C
Storage Temperature	-55°C to 100°C
Absolute Max. Supply Voltage (Vcc)	7V
Absolute Max. Tuning Voltage (Vtune)	6V
All specifications	50 ohm system

Permanent damage may occur if any of these limits are exceeded.

### Outline Drawing

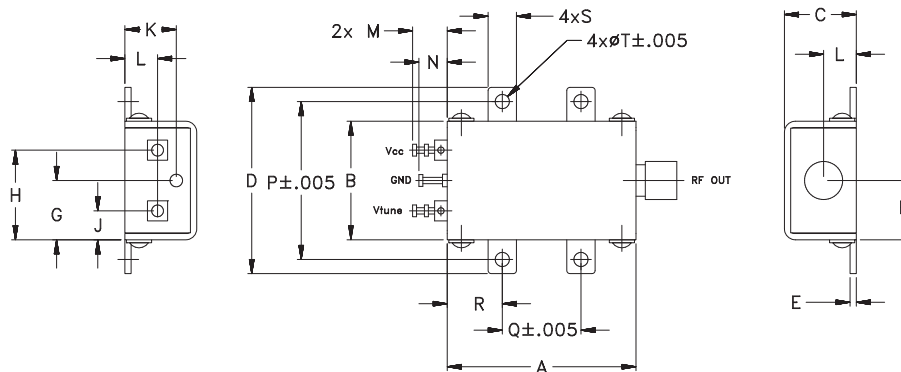

### Outline Dimensions (inch/mm)

A	B	C	D	E	F	G	H	J	K	L	M	N	P	Q	R	S	T	wt.
1.20	.75	.46	1.18	.04	.38	.38	.57	.18	.33	.21	.22	.18	1.00	.50	.35	.18	.106	grams
30.48	19.05	11.68	29.97	1.02	9.65	9.65	14.48	4.57	8.38	5.33	5.59	4.57	25.40	12.70	8.89	4.57	2.69	35.0

### Notes

- Performance and quality attributes and conditions not expressly stated in this specification document are intended to be excluded and do not form a part of this specification document.
- Electrical specifications and performance data contained in this specification document are based on Mini-Circuit's applicable established test performance criteria and measurement instructions.
- The parts covered by this specification document are subject to Mini-Circuits standard limited warranty and terms and conditions (collectively, "Standard Terms"); Purchasers of this part are entitled to the rights and benefits contained therein. For a full statement of the Standard Terms and the exclusive rights and remedies thereunder, please visit Mini-Circuits' website at [www.minicircuits.com/MCLStore/terms.jsp](http://www.minicircuits.com/MCLStore/terms.jsp)



[www.minicircuits.com](http://www.minicircuits.com) P.O. Box 350166, Brooklyn, NY 11235-0003 (718) 934-4500 sales@minicircuits.com

REV. B  
M151477  
EDR-10518/1  
ZX95-3550+  
RAV  
150604  
Page 1 of 2

# Performance Data & Curves\*

# ZX95-3550+

V TUNE	TUNE SENS (MHz/V)	FREQUENCY (MHz)			POWER OUTPUT (dBm)			Icc (mA)	HARMONICS (dBc)			FREQ. PUSH (MHz/V)	FREQ. PULL (MHz)	PHASE NOISE (dBc/Hz) at offsets				FREQ OFFSET (kHz)	PHASE NOISE at 3450 MHz (dBc/Hz)
		-55°C	+25°C	+85°C	-55°C	+25°C	+85°C		F2	F3	F4			1kHz	10kHz	100kHz	1MHz		
0.00	106.07	3267.0	3245.0	3228.5	2.99	2.94	2.76	35.57	-21.7	-31.5	-47.1	1.08	0.51	-71.50	-98.3	-119.4	-139.4	1.0	-71.83
0.25	95.28	3292.2	3271.6	3255.3	3.01	2.96	2.78	35.62	-22.9	-31.2	-47.7	1.50	1.01	-73.08	-97.7	-119.5	-139.4	2.1	-80.17
0.50	88.28	3315.0	3295.4	3280.2	3.05	2.98	2.80	35.71	-23.7	-31.1	-48.9	1.67	0.83	-73.02	-99.1	-120.0	-139.9	3.5	-86.97
0.75	89.06	3337.8	3317.5	3302.7	3.01	3.03	2.83	35.75	-23.4	-32.8	-48.8	1.77	0.31	-73.38	-98.7	-120.1	-140.0	6.1	-92.78
1.00	85.23	3359.5	3339.7	3324.2	3.02	3.02	2.84	35.76	-23.4	-33.7	-47.9	1.97	0.83	-72.12	-97.7	-119.6	-139.4	8.7	-96.42
1.25	83.19	3380.5	3361.0	3346.1	2.99	3.04	2.83	35.84	-23.1	-34.5	-47.4	1.96	0.91	-70.75	-98.2	-119.7	-139.6	10.0	-97.74
1.50	80.71	3400.7	3381.8	3367.0	2.98	3.01	2.85	35.90	-22.3	-34.7	-47.2	1.94	0.61	-71.15	-98.0	-119.7	-139.8	21.1	-105.16
1.75	84.50	3422.3	3402.0	3387.4	2.96	3.01	2.83	35.92	-22.1	-35.7	-46.2	1.89	0.84	-71.88	-98.2	-119.9	-139.9	36.1	-110.21
2.00	80.59	3442.8	3423.1	3407.3	2.96	3.01	2.81	35.95	-21.7	-37.7	-45.4	1.91	1.05	-70.05	-97.7	-119.5	-139.6	61.7	-115.05
2.25	78.04	3462.7	3443.3	3428.1	2.97	3.01	2.81	36.02	-22.1	-38.1	-45.6	1.75	0.68	-70.14	-98.0	-119.5	-139.6	88.1	-118.30
2.50	75.40	3482.1	3462.8	3447.8	2.95	3.03	2.82	36.05	-21.3	-39.3	-46.0	1.56	0.52	-69.38	-97.9	-119.6	-139.7	100.0	-119.41
2.75	75.81	3501.8	3481.6	3466.8	2.93	3.04	2.82	36.05	-21.6	-40.5	-45.5	1.37	0.81	-71.68	-98.0	-119.5	-139.6	150.5	-123.08
3.00	70.68	3520.1	3500.6	3485.1	2.94	3.00	2.83	36.06	-21.4	-42.5	-45.7	1.17	0.86	-70.87	-97.0	-119.2	-139.3	179.9	-124.67
3.25	66.45	3537.6	3518.3	3503.3	2.90	3.00	2.81	36.07	-21.8	-42.0	-45.4	0.94	0.73	-72.10	-97.4	-119.4	-139.5	215.0	-126.25
3.50	62.44	3554.3	3534.9	3520.0	2.82	2.98	2.80	36.05	-21.9	-42.4	-45.5	0.78	0.68	-71.63	-97.3	-119.3	-139.6	307.3	-129.41
3.75	58.65	3570.0	3550.5	3535.7	2.77	2.91	2.77	36.01	-22.5	-41.8	-46.2	0.71	0.78	-70.23	-97.1	-119.2	-139.4	360.8	-130.70
4.00	52.82	3584.2	3565.1	3550.2	2.71	2.87	2.71	35.98	-22.7	-41.5	-45.9	0.69	0.94	-70.32	-97.3	-119.4	-139.4	506.4	-133.82
4.25	47.32	3597.1	3578.3	3563.8	2.69	2.84	2.65	35.96	-22.6	-40.8	-46.3	0.74	0.81	-68.98	-97.8	-119.5	-139.6	605.4	-135.36
4.50	42.36	3608.7	3590.2	3575.9	2.65	2.79	2.64	35.94	-22.9	-41.2	-45.9	0.85	0.66	-69.23	-97.0	-119.5	-139.7	997.8	-139.55
5.00	35.30	3629.0	3610.3	3596.4	2.65	2.76	2.56	35.88	-23.6	-40.9	-45.4	1.20	0.49	-69.81	-97.0	-119.6	-139.7	1000.0	-139.57

\*at 25°C unless mentioned otherwise

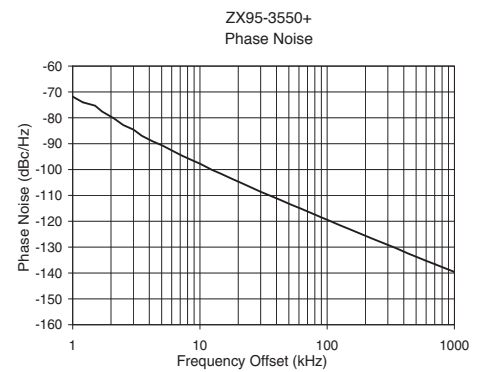
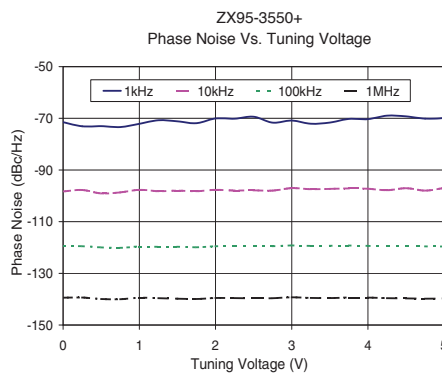
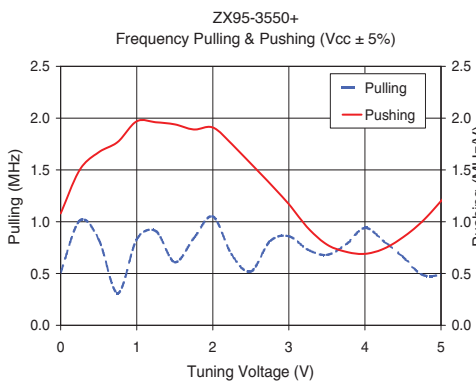
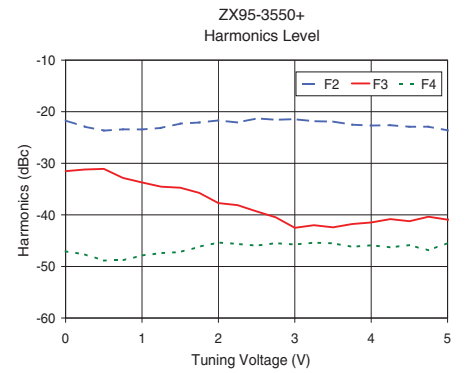
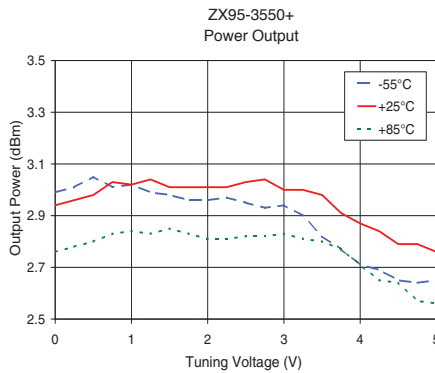
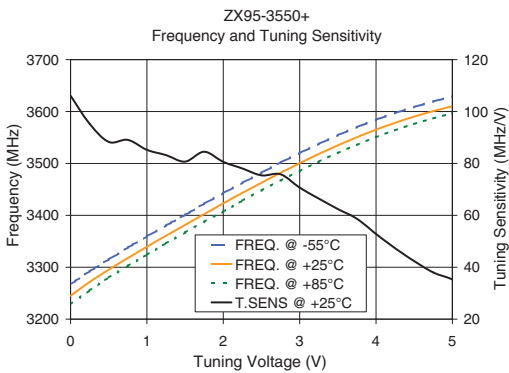

### Notes

- A. Performance and quality attributes and conditions not expressly stated in this specification document are intended to be excluded and do not form a part of this specification document.
- B. Electrical specifications and performance data contained in this specification document are based on Mini-Circuit's applicable established test performance criteria and measurement instructions.
- C. The parts covered by this specification document are subject to Mini-Circuits standard limited warranty and terms and conditions (collectively, "Standard Terms"); Purchasers of this part are entitled to the rights and benefits contained therein. For a full statement of the Standard Terms and the exclusive rights and remedies thereunder, please visit Mini-Circuits' website at [www.minicircuits.com/MCLStore/terms.jsp](http://www.minicircuits.com/MCLStore/terms.jsp)



[www.minicircuits.com](http://www.minicircuits.com) P.O. Box 350166, Brooklyn, NY 11235-0003 (718) 934-4500 sales@minicircuits.com