

Coaxial

Voltage Controlled Oscillator

ZX95-1420+

Linear Tuning 1230 to 1420 MHz

Features

- linear tuning characteristics
- low phase noise
- low pushing
- protected by US patent 6,790,049

Applications

- r & d
- lab
- instrumentation
- wireless communications
- mobile TV
- radio & radar astronomy



CASE STYLE: GB956

Connectors	Model
SMA	ZX95-1420-S+

+RoHS Compliant
The +Suffix identifies RoHS Compliance. See our web site for RoHS Compliance methodologies and qualifications

Electrical Specifications

MODEL NO.	FREQ. (MHz)		POWER OUTPUT (dBm)	PHASE NOISE dBc/Hz SSB at offset frequencies, kHz				TUNING					NON HARMONIC SPURIOUS (dBc)	HARMONICS (dBc)		PULLING pk-pk @ 12 dB (MHz)	PUSHING (MHz/V)	DC OPERATING POWER	
	Min.	Max.		Typ.	1	10	100	1000	VOLTAGE RANGE (V)	SENSI- TIVITY (MHz/V)	PORT CAP (pF)	3 dB MODULATION BANDWIDTH (MHz)		Typ.	Typ.			Max.	Typ.
ZX95-1420+	1230	1420	+6	-85	-111	-131	-151	0.5	28	10-15	65	50	-90	-21	-10	1.5	0.5	5	35

Maximum Ratings

Operating Temperature	-55°C to 85°C
Storage Temperature	-55°C to 100°C
Absolute Max. Supply Voltage (Vcc)	6V
Absolute Max. Tuning Voltage (Vtune)	30V
All specifications	50 ohm system

Permanent damage may occur if any of these limits are exceeded.



NOTE: When soldering the DC connections, caution must be used to avoid overheating the DC terminals. See Application Note AN-40-10.

Outline Drawing

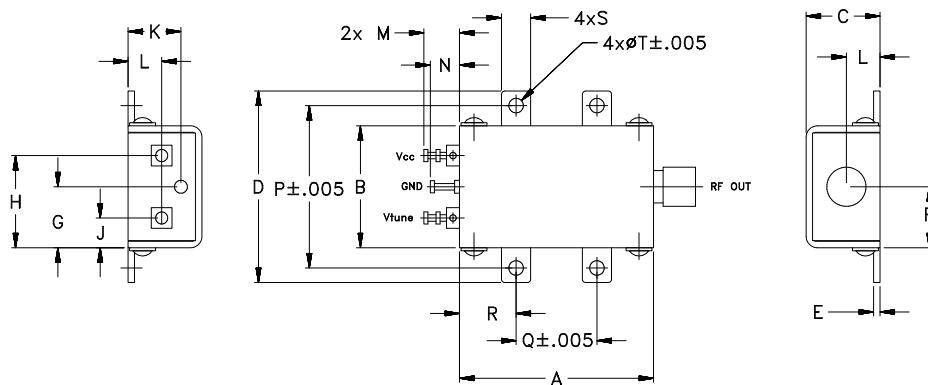

Outline Dimensions (inch/mm)

A	B	C	D	E	F	G	H	J	K	L	M	N	P	Q	R	S	T	wt.
1.20	.75	.46	1.18	.04	.38	.38	.57	.18	.33	.21	.22	.18	1.00	.50	.35	.18	.106	grams
30.48	19.05	11.68	29.97	1.02	9.65	9.65	14.48	4.57	8.38	5.33	5.59	4.57	25.40	12.70	8.89	4.57	2.69	35.0

Notes

- Performance and quality attributes and conditions not expressly stated in this specification document are intended to be excluded and do not form a part of this specification document.
- Electrical specifications and performance data contained in this specification document are based on Mini-Circuit's applicable established test performance criteria and measurement instructions.
- The parts covered by this specification document are subject to Mini-Circuits standard limited warranty and terms and conditions (collectively, "Standard Terms"); Purchasers of this part are entitled to the rights and benefits contained therein. For a full statement of the Standard Terms and the exclusive rights and remedies thereunder, please visit Mini-Circuits' website at www.minicircuits.com/MCLStore/terms.jsp



www.minicircuits.com P.O. Box 350166, Brooklyn, NY 11235-0003 (718) 934-4500 sales@minicircuits.com

REV. C
M152326
EDR-8790F2
ZX95-1420+
RAV
150923
Page 1 of 2

Performance Data & Curves*

ZX95-1420+

V TUNE	TUNE SENS (MHz/V)	FREQUENCY (MHz)			POWER OUTPUT (dBm)			Icc (mA)	HARMONICS (dBc)			FREQ. PUSH (MHz/V)	FREQ. PULL (MHz)	PHASE NOISE (dBc/Hz) at offsets				FREQ OFFSET (KHz)	PHASE NOISE at 1315 MHz (dBc/Hz)
		-55°C	+25°C	+85°C	-55°C	+25°C	+85°C		F2	F3	F4			1kHz	10kHz	100kHz	1MHz		
0.00	10.73	1172.1	1169.6	1168.8	6.08	5.75	5.33	25.18	-15.5	-35.2	-34.8	0.06	1.94	-84.2	-107.3	-129.3	-149.2	1.0	-84.82
0.50	9.96	1177.2	1175.0	1174.3	6.17	5.84	5.41	25.33	-15.8	-37.0	-34.7	0.01	1.94	-84.4	-108.6	-129.5	-149.7	2.0	-93.75
2.00	9.31	1191.3	1189.5	1189.1	6.40	6.01	5.59	25.66	-16.8	-43.4	-34.7	0.10	1.46	-84.9	-109.4	-130.4	-150.4	3.5	-100.16
4.00	11.24	1210.5	1209.0	1208.3	6.57	6.06	5.73	25.86	-17.3	-39.6	-34.9	0.02	1.11	-87.1	-110.7	-131.6	-152.2	6.0	-106.11
6.00	13.40	1235.0	1232.6	1231.5	6.34	6.02	5.79	26.00	-18.3	-33.9	-35.0	0.19	1.83	-85.9	-112.2	-133.5	-153.2	8.5	-109.55
8.00	14.60	1262.9	1260.1	1258.6	6.17	5.93	5.78	26.11	-19.5	-29.1	-35.7	0.41	1.12	-86.0	-111.7	-133.3	-152.6	10.0	-111.27
9.00	14.97	1277.8	1274.7	1273.0	6.08	5.88	5.76	26.06	-20.0	-28.9	-34.9	0.54	1.22	-84.4	-112.3	-133.4	-152.8	20.8	-118.59
10.00	15.21	1293.1	1289.7	1287.8	6.03	5.86	5.76	25.98	-20.6	-27.3	-35.1	0.68	1.68	-83.7	-111.6	-132.9	-152.3	35.5	-123.49
11.00	15.22	1308.5	1304.9	1302.9	5.95	5.80	5.70	25.92	-21.0	-27.1	-34.9	0.78	1.99	-83.7	-112.1	-132.3	-151.0	60.7	-127.50
12.00	15.06	1323.9	1320.1	1318.1	5.92	5.74	5.63	25.85	-21.3	-26.4	-34.7	0.85	1.32	-85.0	-111.6	-132.2	-152.0	86.7	-131.38
13.00	14.62	1339.0	1335.2	1333.1	5.85	5.66	5.56	25.77	-21.8	-25.8	-33.9	0.86	0.99	-85.3	-110.5	-132.0	-151.5	100.0	-132.75
14.00	14.04	1353.7	1349.8	1347.6	5.84	5.64	5.52	25.68	-22.4	-25.8	-33.0	0.84	1.92	-85.4	-110.8	-132.0	-152.2	148.1	-136.02
15.00	13.25	1367.9	1363.8	1361.6	5.81	5.60	5.48	25.58	-22.3	-24.9	-33.4	0.82	2.01	-85.3	-110.8	-132.3	-152.0	177.0	-137.56
16.00	12.39	1381.2	1377.1	1374.8	5.80	5.58	5.45	25.50	-22.4	-25.7	-32.3	0.80	1.68	-84.2	-110.8	-132.3	-151.3	211.6	-139.26
18.00	10.59	1405.3	1401.0	1398.6	5.77	5.52	5.38	25.42	-22.5	-24.8	-32.1	0.85	1.50	-85.5	-110.3	-131.9	-151.9	302.4	-142.09
20.00	9.01	1425.8	1421.3	1418.9	5.78	5.51	5.35	25.35	-22.4	-25.0	-32.6	0.92	2.08	-86.7	-111.2	-132.5	-151.7	361.5	-143.52
22.00	7.84	1443.4	1438.7	1436.2	5.76	5.50	5.33	25.25	-22.7	-24.8	-32.6	0.94	1.59	-86.3	-111.1	-132.3	-151.1	507.5	-146.85
24.00	6.61	1458.6	1453.8	1451.2	5.67	5.41	5.24	25.18	-22.6	-25.0	-32.2	0.86	1.16	-86.8	-111.0	-132.6	-150.9	606.7	-148.30
26.00	5.33	1471.4	1466.4	1463.7	5.60	5.35	5.19	25.12	-22.4	-24.7	-32.6	0.63	2.09	-84.9	-112.1	-132.0	-151.6	851.6	-150.92
28.00	3.95	1481.6	1476.3	1473.6	5.56	5.33	5.17	25.08	-22.0	-25.2	-32.2	0.44	2.29	-87.6	-111.1	-132.3	-151.3	1000.0	-152.36

*at 25°C unless mentioned otherwise

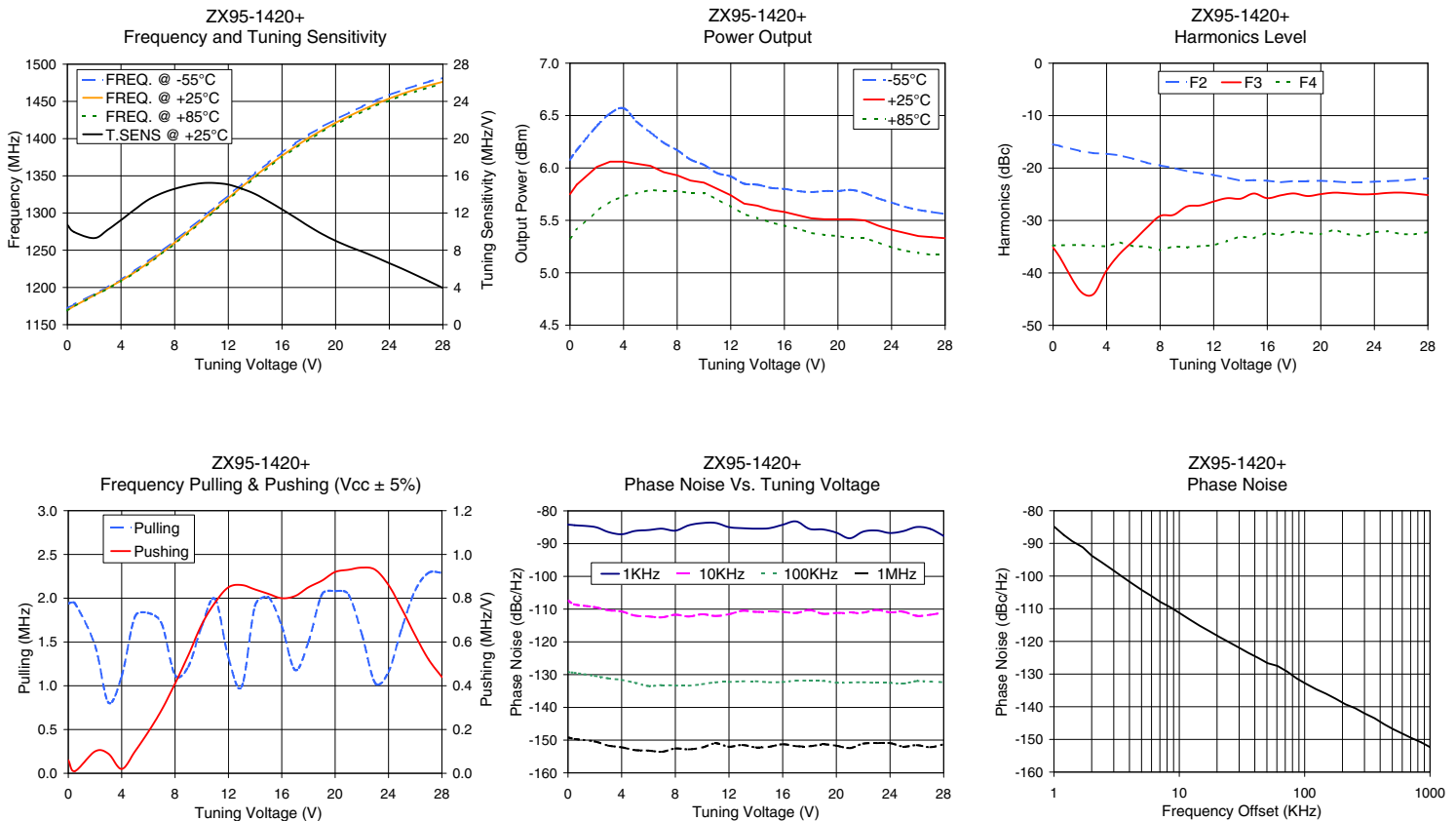

Notes

- A. Performance and quality attributes and conditions not expressly stated in this specification document are intended to be excluded and do not form a part of this specification document.
- B. Electrical specifications and performance data contained in this specification document are based on Mini-Circuit's applicable established test performance criteria and measurement instructions.
- C. The parts covered by this specification document are subject to Mini-Circuits standard limited warranty and terms and conditions (collectively, "Standard Terms"); Purchasers of this part are entitled to the rights and benefits contained therein. For a full statement of the Standard Terms and the exclusive rights and remedies thereunder, please visit Mini-Circuits' website at www.minicircuits.com/MCLStore/terms.jsp

